

THIS DRAWING IS UNPUBLISHED. RELEASED FOR PUBLICATION
 © COPYRIGHT BY TYCO ELECTRONICS CORPORATION. ALL RIGHTS RESERVED.

| | | | | | | | |
|-----|------|-----------|-----|-----------------------|---------|-----|------|
| LOC | DIST | REVISIONS | | | | | |
| AF | 50 | P | LTR | DESCRIPTION | DATE | DWN | APVD |
| | | | H1 | REV PER ECR-06-018933 | 11AUG06 | HMR | KR |

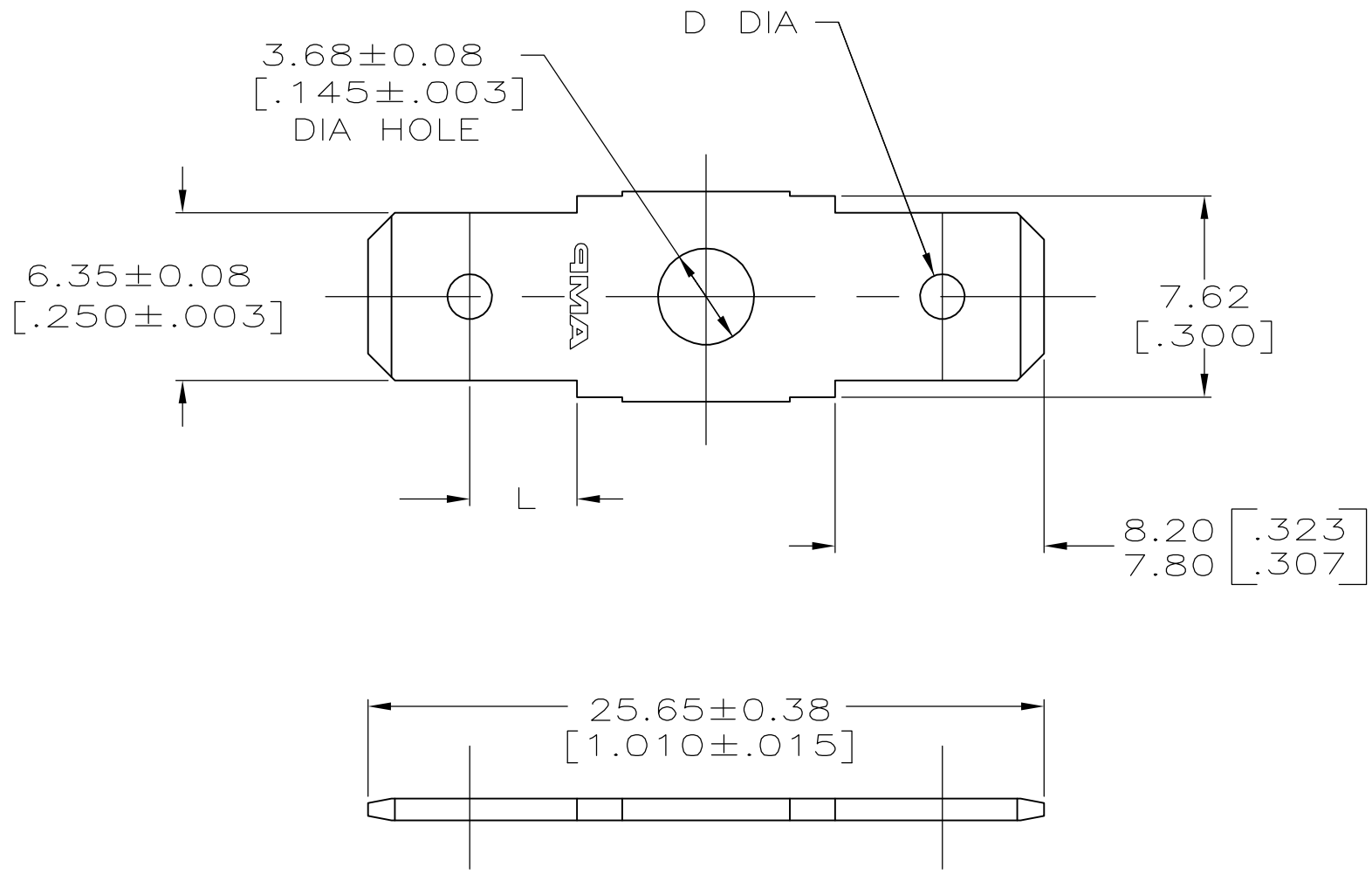

- 1 SUPPLIED IN LOOSE PIECE.
- 2 ELECTRICAL TEST TAB ONLY.
- 3 PRELIMINARY - NOT FOR PRODUCTION

| | | | | |
|--|--------------------------|----------------------------|-----------------------------------|----------------------|
| 2.03 [.080] 1.93 [.076] DIA HOLE | 4.01±0.08 [.158±.003] | 0.002032 [.000080] MIN TIN | 0.813±0.012 [.032±.0005] CR STEEL | 62627-4 ³ |
| 2.03 [.080] 1.65 [.065] DIA HOLE | 3.40±0.08 [.134±.003] | - | 0.813±0.007 [.032±.0003] BRASS | 62627-3 |
| 2.03 [.080] 1.65 [.065] DIA DIMPLE | 4.06±0.08 [.160±.003] | - | 0.813±0.007 [.032±.0003] BRASS | 62627-2 |
| | | 0.002032 [.000080] MIN TIN | 0.813±0.012 [.032±.0005] CR STEEL | 62627-1 ² |
| DIM D | DIM L | FINISH | MATERIAL | PART NO. |

THIS DRAWING IS A CONTROLLED DOCUMENT.

| | | | |
|----------------------------|---|------------------------------|---|
| DIMENSIONS: mm [INCHES] | TOLERANCES UNLESS OTHERWISE SPECIFIED: | DWN JR RUTH 8/6/96 | Tyco Electronics Corporation Harrisburg, PA 17105-3608 |
| | 0 PLC ± - 1 PLC ± - 2 PLC ± 0.25 [.010] 3 PLC ± - 4 PLC ± - ANGLES ± - | CHK MS FEHER 8/6/96 | |
| | | APVD P DESANTIS 8/6/96 | |
| | | PRODUCT SPEC - | |
| MATERIAL SEE TABLE | FINISH SEE TABLE | APPLICATION SPEC - | NAME TAB, FASTON, 6.35 [.250] SERIES |
| | | WEIGHT - | SIZE A3 |
| | | CUSTOMER DRAWING | CAGE CODE 00779 |
| | | | DRAWING NO C-62627 |
| | | | RESTRICTED TO - |
| | | | SCALE 4:1 |
| | | | SHEET 1 OF 1 |
| | | | REV H1 |