

DESIGNED & DIMENSIONED
IN MILLIMETERS
(INCHES FOR REFERENCE ONLY)

HSEC8-1XX-XX-X-D-EMXX

DO NOT
SCALE FROM
THIS PRINT

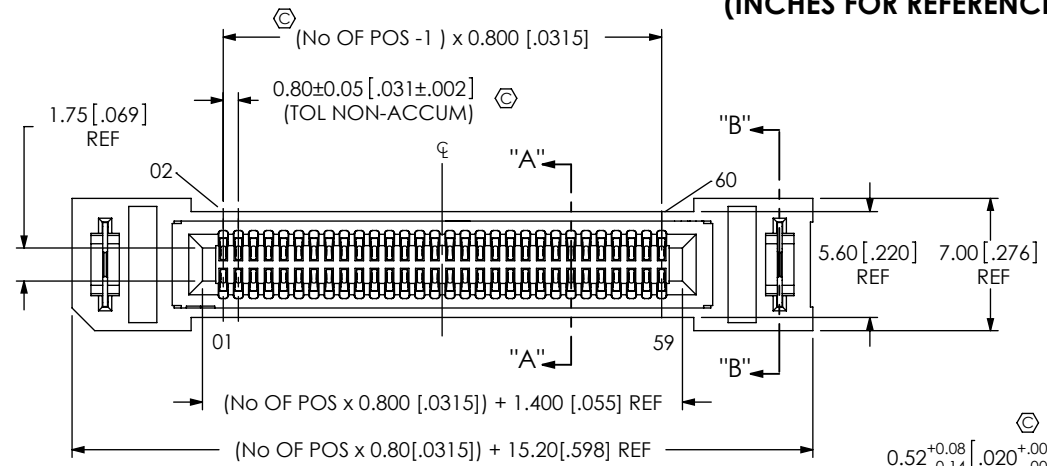

No OF POSITIONS
-10, -20, & -30 (SEE FIG. 1)
-13, -25, -37, -40, -49,
-50, & -60 (SEE FIG. 2)
(PER ROW)

CARD THICKNESS
-01: 1.57mm [.062] THICK CARD

PLATING SPECIFICATION
-S: 30µ" SELECTIVE GOLD IN CONTACT AREA,
MATTE TIN ON TAIL
-L: 10µ" LIGHT SELECTIVE GOLD IN CONTACT AREA,
MATTE TIN ON TAIL

TAIL OPTION
-EM2: 1.57mm [.062] THICK PCB
-EM2L: 1.57mm [.062] THICK PCB
WITH WELD TAB LATCH
(SHT. 3, FIG. 3) (AVAILABLE
ONLY IN 13, 25, 37 & 49
POSITIONS)

ROW SPECIFICATION
-D: DOUBLE
(USE HSEC8-XX-01-D-EM2X)

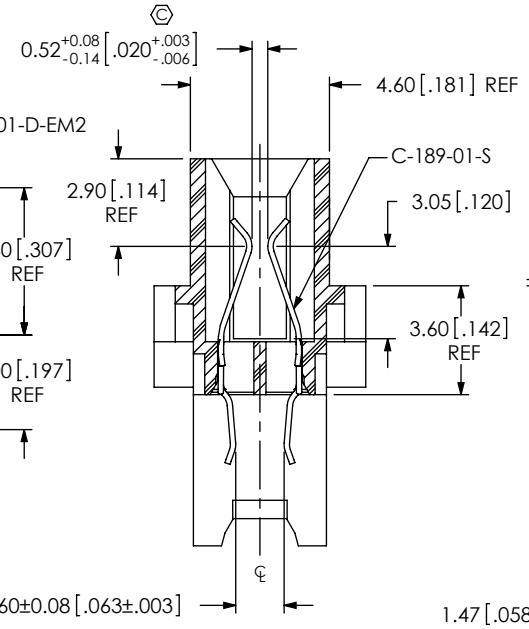
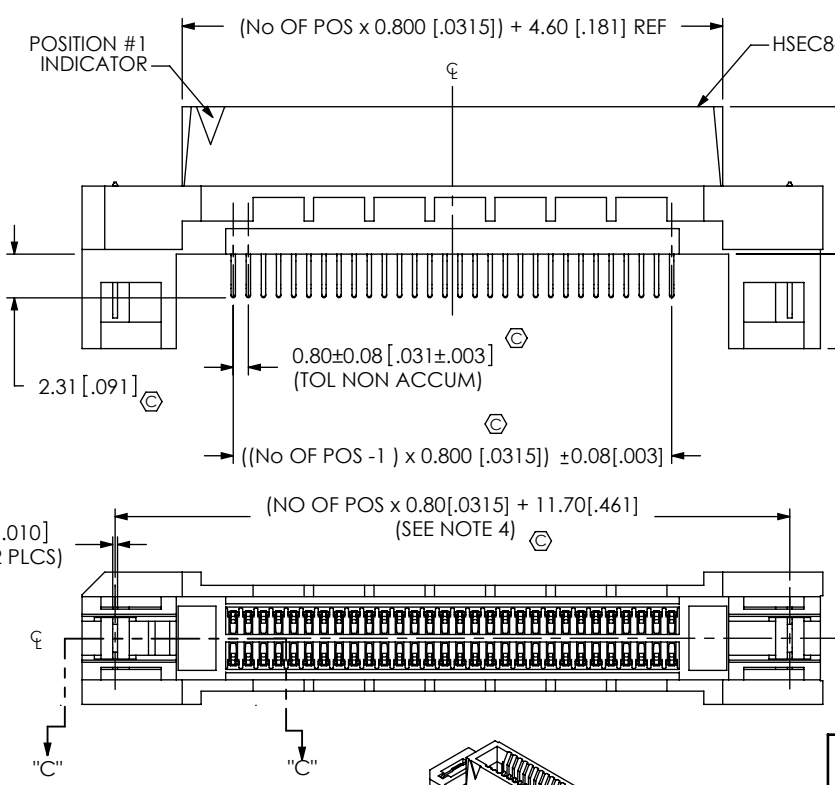

SECTION "A"- "A"
SCALE 4 : 1

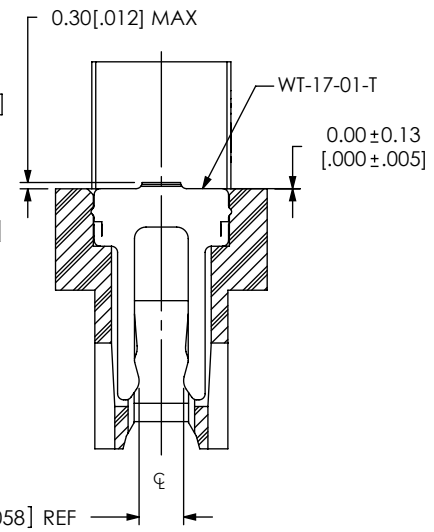

SECTION "B"- "B"
SCALE 4 : 1

FIG 1

FOR POSITIONS -10, -20 & -30
(SHOWN: HSEC8-130-01-S-D-EM2)

NOTES:

1. Ⓢ REPRESENTS A CRITICAL DIMENSION.
2. BURR ALLOWANCE: 0.04 [.0015] MAX.
3. MINIMUM PUSHOUT FORCE: 2.22 NEWTONS.
4. ALL TAIL TO TAIL DIMENSIONS TO BE MEASURED FROM TIP TO TIP.

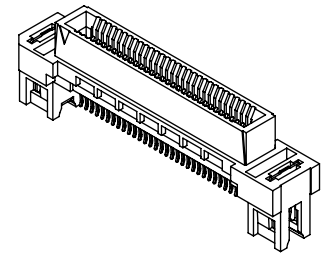

<p>UNLESS OTHERWISE SPECIFIED, DIMENSIONS ARE IN MILLIMETERS.</p> <p>TOLERANCES ARE:</p> <p>DECIMALS ANGLES</p> <p>.X: ± 0.3 [.01] 2°</p> <p>.XX: ± 0.13 [.005]</p> <p>.XXX: ± 0.051 [.0020]</p>	<p>PROPRIETARY NOTE</p> <p>THIS DOCUMENT CONTAINS INFORMATION CONFIDENTIAL AND PROPRIETARY TO SAMTEC, INC. AND SHALL NOT BE REPRODUCED OR TRANSFERRED TO OTHER DOCUMENTS OR DISCLOSED TO OTHERS OR USED FOR ANY PURPOSE OTHER THAN THAT WHICH IT WAS OBTAINED WITHOUT THE EXPRESSED WRITTEN CONSENT OF SAMTEC, INC.</p>	<p>520 PARK EAST BLVD, NEW ALBANY, IN 47150 PHONE: 812-944-6733 FAX: 812-948-5047 e-Mail info@SAMTEC.com code 55322</p>
<p>F:\DWG\MISC\MKTG\HSEC8-1XX-XX-X-D-EMXX-MKT.SLDDRW</p>		<p>BY: BRATCHER 01/27/03 SHEET 1 OF 3</p>

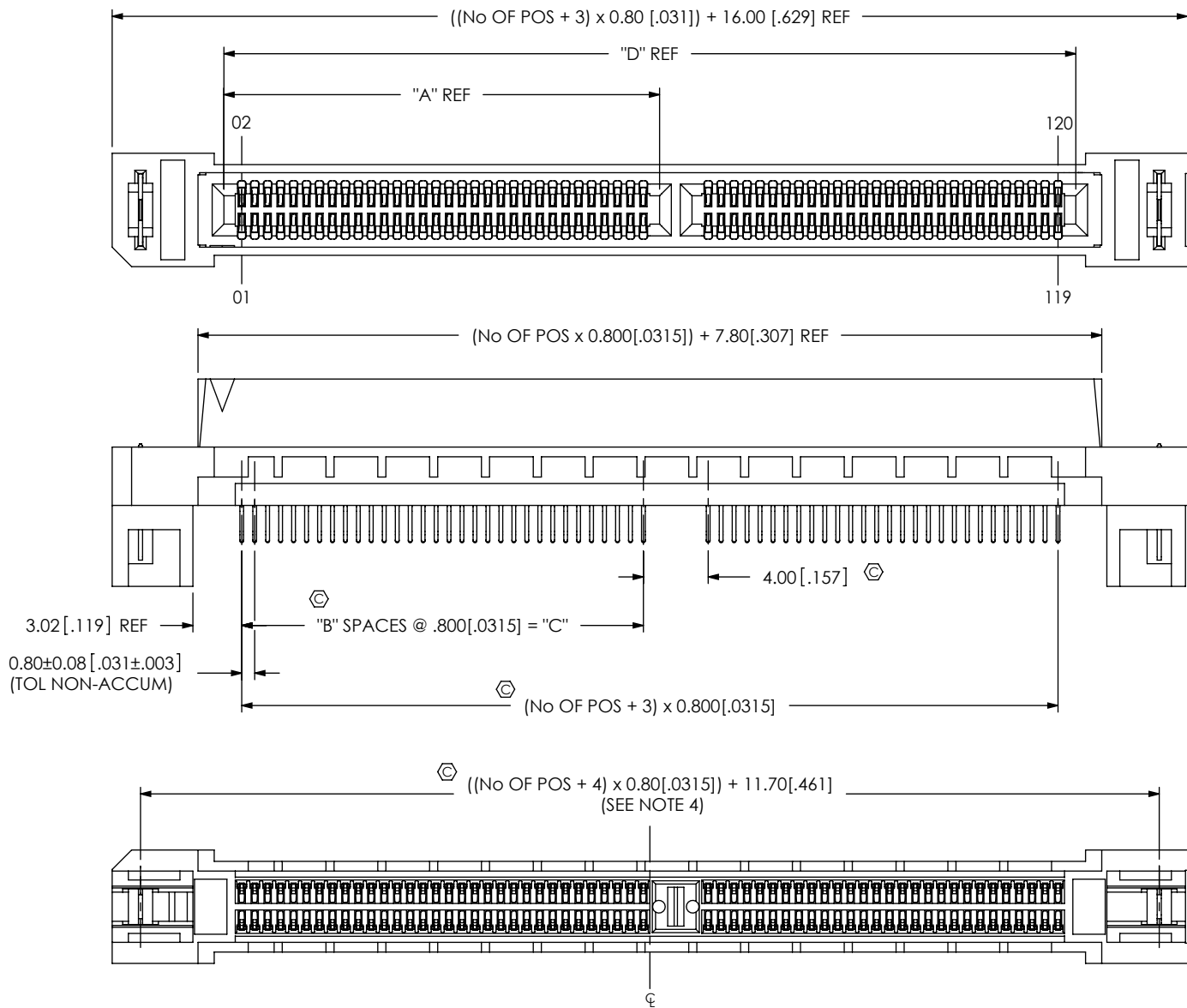

PACKAGING VIEW
 FOR EM2
 (PARTS TO HAVE POSITION #1 LOADED IN
 SAME DIRECTION AS ARROW ON TUBE)

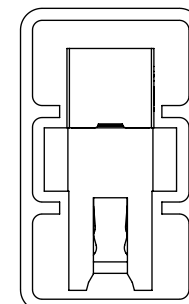

TUBE: PT-1-24-02-125
 PLUG: TP-03

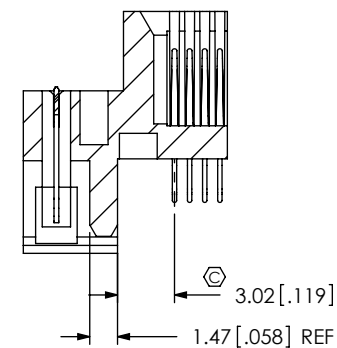

SECTION "C"- "C"

FIG 2

FOR POSITIONS -13, -25, -37, -40, -49, -50, -60
 (SAME AS FIG 1, UNLESS OTHERWISE STATED)
 (SHOWN: HSEC8-160-01-S-D-EM2)

No OF POS	"A" REF	"B"	"C"	"D" REF
-13	6.10 [.240]	5	4.000 [.1575]	15.00 [.591]
-25	6.10 [.240]	5	4.000 [.1575]	24.60 [.969]
-37	18.10 [.713]	20	16.000 [.6299]	34.20 [1.346]
-40	18.90 [.744]	21	16.800 [.6614]	36.600 [1.441]
-49	22.90 [.902]	26	20.800 [.8189]	43.80 [1.724]
-50	22.90 [.902]	26	20.800 [.8189]	44.60 [1.756]
-60	26.90 [1.059]	31	24.800 [.9763]	52.60 [2.071]

PROPRIETARY NOTE

THIS DOCUMENT CONTAINS INFORMATION
 CONFIDENTIAL AND PROPRIETARY TO
 SAMTEC, INC. AND SHALL NOT BE REPRODUCED
 OR TRANSFERRED TO OTHER DOCUMENTS OR
 DISCLOSED TO OTHERS OR USED FOR ANY
 PURPOSE OTHER THAN THAT WHICH IT WAS
 OBTAINED WITHOUT THE EXPRESSED WRITTEN
 CONSENT OF SAMTEC, INC.

DO NOT SCALE DRAWING

SHEET SCALE: 1:0.4



520 PARK EAST BLVD., NEW ALBANY, IN 47150
 PHONE: 812-944-6733 FAX: 812-948-5047
 e-Mail info@SAMTEC.com code 55322

DESCRIPTION:
 0.8mm HIGH SPEED, DUAL EDGE MOUNT, MINI-EDGE CARD ASSEMBLY

DWG. NO.
HSEC8-1XX-XX-X-D-EMXX

BY: BRATCHER 01/27/03 SHEET 2 OF 3

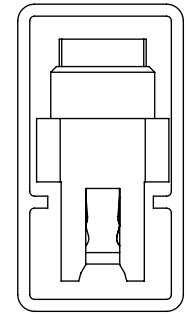
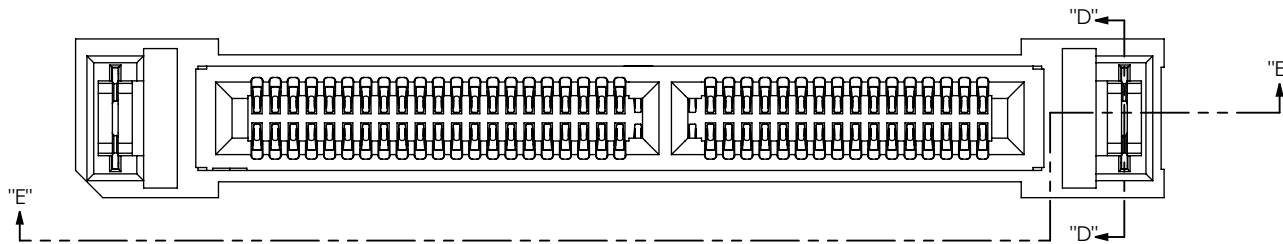

TUBE: PT-1-24-01-108
PLUG: TP-13

PACKAGING VIEW
FOR EM2L

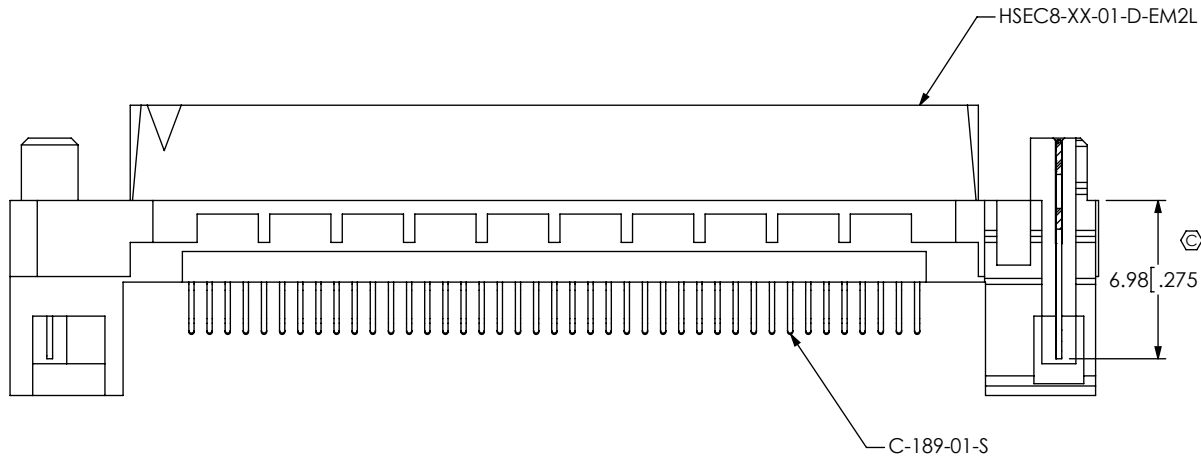

SECTION "E"-"E"

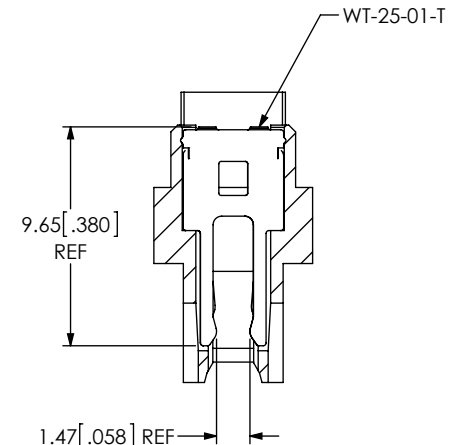

SECTION "D"-"D"

FIG 3

(SAME AS FIG 2, UNLESS OTHERWISE STATED)
(SHOWN: HSEC8-137-01-S-D-EM2L)

PROPRIETARY NOTE
THIS DOCUMENT CONTAINS INFORMATION CONFIDENTIAL AND PROPRIETARY TO SAMTEC, INC. AND SHALL NOT BE REPRODUCED OR TRANSFERRED TO OTHER DOCUMENTS OR DISCLOSED TO OTHERS OR USED FOR ANY PURPOSE OTHER THAN THAT WHICH IT WAS OBTAINED WITHOUT THE EXPRESSED WRITTEN CONSENT OF SAMTEC, INC.

DO NOT SCALE DRAWING

SHEET SCALE: 1:0.333333

samtec

520 PARK EAST BLVD, NEW ALBANY, IN 47150
PHONE: 812-944-6733 FAX: 812-948-5047
e-Mail info@SAMTEC.com code 55322

DESCRIPTION:
0.8mm HIGH SPEED, DUAL EDGE MOUNT, MINI-EDGE CARD ASSEMBLY

DWG. NO.
HSEC8-1XX-XX-X-D-EMXX

BY: BRATCHER 01/27/03 SHEET 3 OF 3