

Surge protection device - CN-UB-70DC-6-SB - 2803153

Please be informed that the data shown in this PDF Document is generated from our Online Catalog. Please find the complete data in the user's documentation. Our General Terms of Use for Downloads are valid (<http://phoenixcontact.com/download>)



Attachment plug with surge protection for coaxial signal interfaces. Connection: N connector, male/female

Why buy this product

- Mounting plate enables mounting, e.g., in a control cabinet

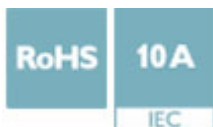

Key Commercial Data

Packing unit	1 STK
GTIN	 4 046356 293204
GTIN	4046356293204

Technical data

Dimensions

Height	24 mm
Width	24 mm
Depth	50 mm

Ambient conditions

Ambient temperature (operation)	-40 °C ... 90 °C
Degree of protection	IP68
	IP68

General

Housing material	Brass (CuZn)
Color	nickel
Standards for clearances and creepage distances	DIN VDE 0110-1
	IEC 60664-1
Mounting type	Connection-specific intermediate plugging
Type	Attachment plug

Surge protection device - CN-UB-70DC-6-SB - 2803153

Technical data

General

Direction of action	Line-Shield/Earth Ground
---------------------	--------------------------

Additional descriptions

Note	To meet the discharge conditions for DC voltages, please note the following information: "The surge protective device should be used together with a transmitter unit, which shuts down in the event of a short-circuit."
------	---

Protective circuit

IEC test classification	C2
	C3
	D1
VDE requirement class	C2
	C3
	D1
Maximum continuous voltage U_C	70 V DC
	50 V AC
Maximum continuous voltage U_C (line-earth)	70 V DC
	50 V AC
Rated current	10 A
Operating effective current I_C at U_C	$\leq 1 \mu A$
Nominal discharge current I_n (8/20) μs	5 kA
Nominal discharge current I_n (8/20) μs (line-earth)	5 kA
Nominal discharge current I_n (8/20) μs (line-shield)	5 kA
Total discharge current I_{total} (8/20) μs	5 kA
Max. discharge current I_{max} (8/20) μs maximum (line-earth)	10 kA
Max. discharge current I_{max} (8/20) μs maximum (line-shield)	10 kA
Nominal pulse current I_{an} (10/1000) μs (Core-Shield)	100 A
Impulse discharge current (10/350) μs , peak value I_{imp}	1 kA
Output voltage limitation at 1 kV/ μs (line-earth) spike	$\leq 650 V$
Output voltage limitation at 1 kV/ μs (line-shield) spike	$\leq 650 V$
Output voltage limitation at 1 kV/ μs (line-earth) static	$\leq 650 V$
Output voltage limitation at 1 kV/ μs (line-shield) static	$\leq 650 V$
Voltage protection level U_p (line-earth)	$\leq 800 V$ (C2 - 4 kV / 2 kA)
	$\leq 1 kV$ (C2 - 10 kV / 5 kA)
Voltage protection level U_p (line-shield)	$\leq 800 V$ (C2 - 4 kV / 2 kA)
	$\leq 1 kV$ (C2 - 10 kV / 5 kA)
Response time t_A (line-earth)	$\leq 100 ns$
Response time t_A (line-shield)	$\leq 100 ns$
Input attenuation a_E , asym.	0.1 dB ($\leq 6 GHz$)
Cut-off frequency f_g (3 dB), asym. (shield) in 50 Ohm system	$> 6 GHz$
Frequency range	0 Hz ... 6 GHz

Surge protection device - CN-UB-70DC-6-SB - 2803153

Technical data

Protective circuit

Standing wave ratio SWR in a 50 Ω system	typ. 1.15 (≤ 6 GHz)
Permissible HF power P_{max} at VSWR = xx (50 ohm system)	30 W (VSWR = 1.15)
Capacity (line-earth)	typ. 1.5 pF
Capacity asymmetrical (shield)	typ. 1.5 pF
Surge protection fault message	none
Impulse durability (line-earth)	C2 - 10 kV/5 kA C3 - 100 A D1 - 1 kA
Impulse durability (line-shield)	C2 - 10 kV/5 kA C3 - 100 A D1 - 1 kA
Alternating current carrying capacity (line-shield)	5 A - 1 s

Connection data

Connection method	N connector 50 Ω
Connection method IN	N connector, male
Connection method OUT	N connector, female

Standards and Regulations

Standards/regulations	IEC 61643-21
Standards/specifications	IEC 61643-21 2000

Drawings

Circuit diagram

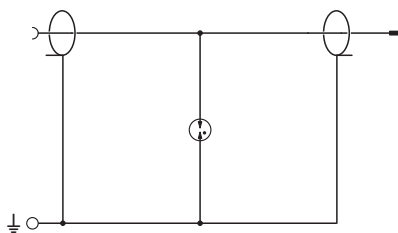

Dimensional drawing

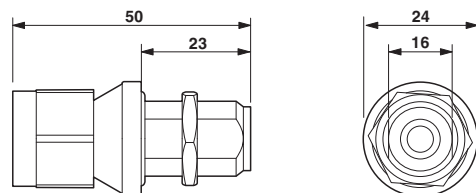

Approvals

Approvals

Approvals

EAC / EAC

Ex Approvals

Surge protection device - CN-UB-70DC-6-SB - 2803153

Approvals

Approval details

EAC		RU C- DE.A*30.B01561
-----	---	-------------------------

EAC		EAC-Zulassung
-----	---	---------------

Phoenix Contact 2018 © - all rights reserved
<http://www.phoenixcontact.com>

PHOENIX CONTACT GmbH & Co. KG
Flachsmarktstr. 8
32825 Blomberg
Germany
Tel. +49 5235 300
Fax +49 5235 3 41200
<http://www.phoenixcontact.com>