

PART NUMBER	REV	FIRST USED	POWER UNIT	FEED TYPE
1852663-1	A	-	BENCH MODEL G	AIRFEED
1852663-2	A	-	BENCH MODEL K	AIRFEED

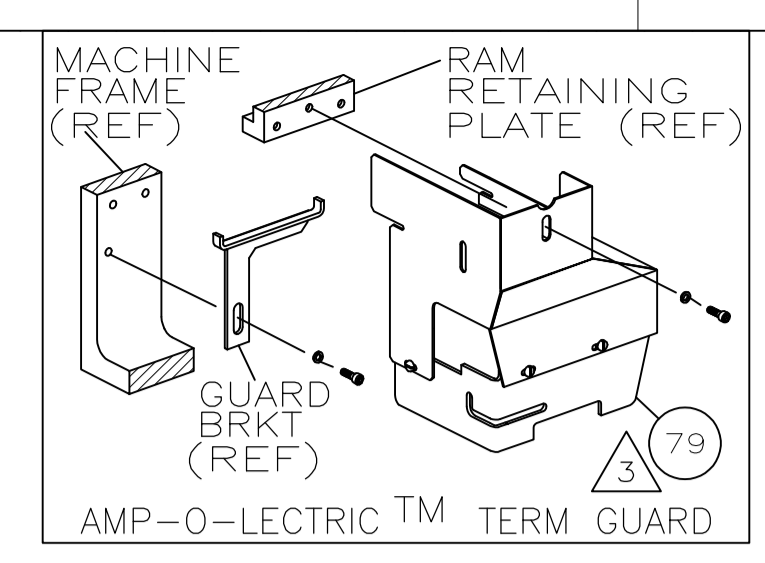

TERMINAL NAME:		62308	
AMP-LIVAR SPLICE			
TERM APPL SPEC 114-2003			

CRIMPING DATA			
PAD LTR	CRIMP HEIGHT	WIRE SIZE	
A	.086 ±.002	6000-7000 CMA	
B	.082 ±.002	5000-5999 CMA	
C	.078 ±.002	4000-4999 CMA	
D	.074 ±.002	3000-3999 CMA	
CRIMP	SIZE	TYPE	RANGE
WIRE	.140	F	3000-7000 CMA
INSUL	-	-	-
FEED	.345	APPL INST 408-8039	SET UP GAGE 458638-1
WIRE STRIP LENGTH		-	

LOC	DIST	REVISIONS			
A	66	F LTR	DESCRIPTION	DATE	DNV
		A	ORIGINAL	-	-

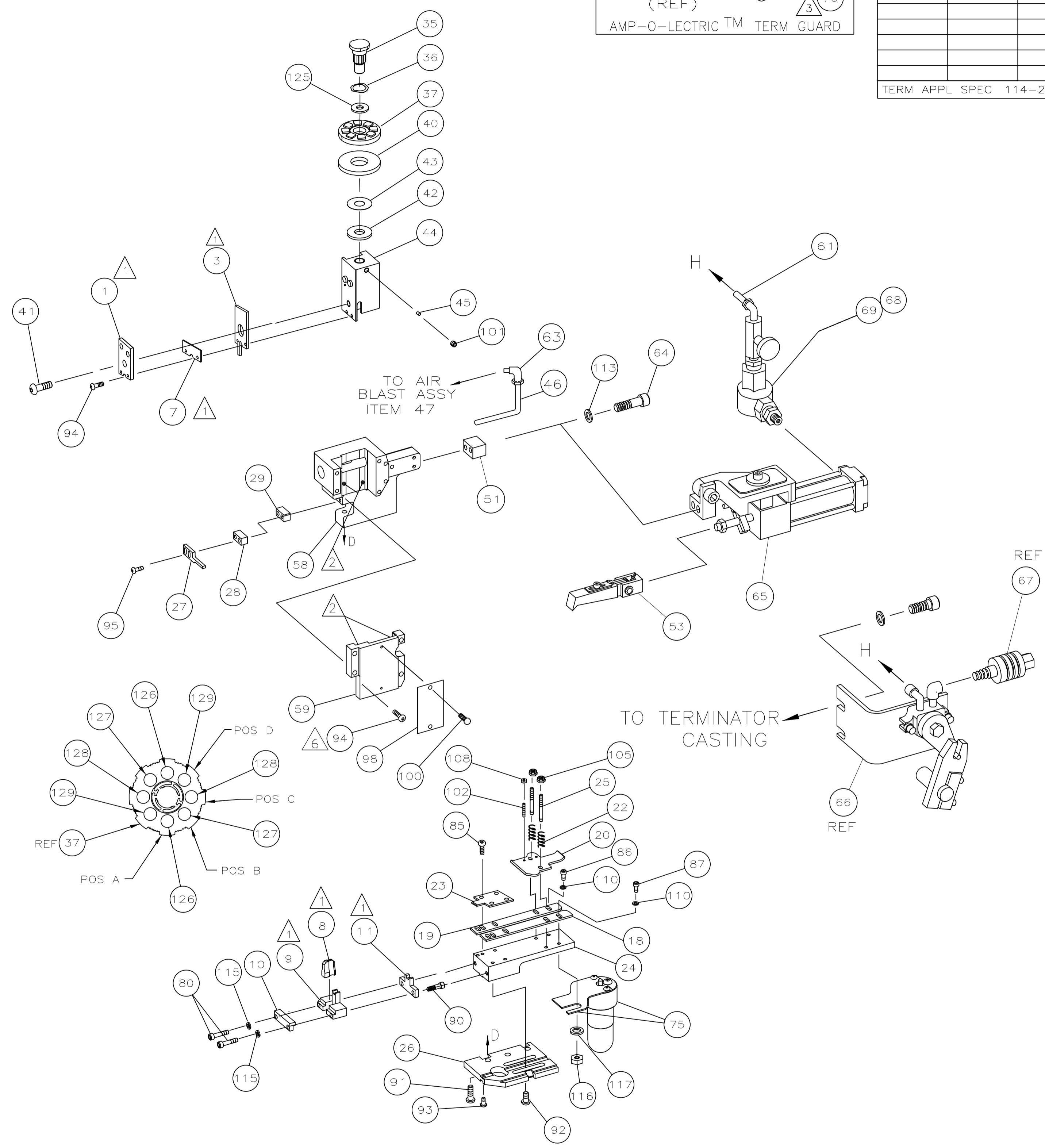

2	2	-	1-354779-4	PIN, WIRE DISC (.3060)D	129
2	2	-	354779-6	PIN, WIRE DISC (.3020)C	128
2	2	-	9-354778-5	PIN, WIRE DISC (.2970)B	127
2	2	-	8-354778-9	PIN, WIRE DISC (.2940)A	126
1	1	-	986950-1	WASHER, FLAT PRECISION	125
					124
					123
					122
					121
					120
					119
					118
1	1	-	21055-6	WASHER,FLAT(#6)LUB	117
1	1	-	21018-6	NUT, HEX (8-32)LUBE	116
2	2	-	21024-3	WASHER,LOCK(#6)RET PLATE	115
					114
4	4	-	21024-5	WASHER,LOCK(NO.10)SHEAR PL	113
					112
					111
2	2	-	21024-4	WASHER,LOCK(NO.8)SHEAR BL	110
					109
2	2	-	21018-4	NUT,HEX(4-40)DRAG	108
					107
					106
2	2	-	21022-2	NUT,HEX SL(8-32)DRAG STUD	105
					104
					103
2	2	-	4-21078-8	SKT SKT SET (4-40x.75)DRAG	102
1	1	-	21009-2	SCR,SKT SET(1/4-20x.25)RAM	101
2	2	-	21017-2	SCR,DRIVE(#2x.19)ID PLATE	100
					99
1	1	-	464249-1	PLATE, IDENTIFICATION	98
					97
					96
4	4	-	3-21000-1	SCR,SHC(8-32x1.00)STRIPPER	95
6	6	-	2-21002-9	SCR,BHC(10-32x.75)CAP	94
2	2	-	2-22733-0	SCR,SHC(10-32X.38)ANVIL	93
4	4	-	3-21002-4	SCR,BHC(1/4-20x.63)ST GD PL	92
3	3	-	2-22733-8	SCR,BHC(1/4-20x.62)HSG	91
2	2	-	1-21002-6	SCR,BHC(6-32x.25)PLATE GUIDE	90
					89
					88
					87
1	1	-	2-21000-9	SCR,SHC(8-32X.75)STRIP GUIDE	87
1	1	-	2-21000-6	SCR,SHC(8-32x.38)STRIP GUIDE	86
4	4	-	2-21002-2	SCR,BHC(8-32X.50)STRIP GUIDE	85
					84
					83
					82
					81
					80
2	2	-	1-21000-9	SCR,SHC(6-32X.88)SH PL	80
1	-	-	460980-2	GUARD ASSY	79
					78
					77
					76
1	-	-	1-465184-7	LUBRICATOR ASSEMBLY	75
					74
					73
					72
					71
					70
					69
					68
					67
					66
					65
					64
					63
					62
					61
					60
					59
					58
					57
					56
					55
					54
					53
					52
					51
					50
					49
					48
					47
					46
					45
					44
					43
					42
					41
					40
					39
					38
					37
					36
					35
					34
					33
					32
					31
					30
					29
					28
					27
					26
					25
					24
					23
					22
					21
					20
					19
					18
					17
					16
					15
					14
					13
					12
					11
					10
					9
					8
					7
					6
					5
					4
					3
					2
					1

4	1	-	692655-1	AIR FEED VALVE ASSY	69
					68
					67
					66
4	1	1	460277-1	AIR FEED ASSY	65
					64
					63
					62
					61
					60
					59
					58
					57
					56
					55
					54
4	1	1	2-460680-9	FEED FINGER ASSY	53
					52
					51
					50
					49
					48
					47
					46
					45
					44
					43
					42
					41
					40
					39
					38
					37
					36
					35
					34
					33
					32
					31
					30
					29
					28
					27
					26
					25
					24
					23
					22
					21
					20
					19
					18
					17
					16
					15
					14
					13
					12
1	1	1	459684-4	PLATE, REAR SHEAR	11
					10
					9
1	1	1	459582-8	ANVIL	8
					7
					6
					5
					4
					3
1	1	1	459587-1	GUIDE, CRIMPER	3
					2
					1
1	1	1	2-459585-1	CRIMPER, WIRE	1

- 1 RECOMMENDED SPARE PARTS.
- 2 GREASE LIGHTLY.
- 3 GUARD MUST BE IN PLACE WHEN OPERATING APPLICATOR IN A BENCH MACHINE.
- 4 SEE DRAWING FOR COMPONENTS
- 5 RECOMMENDED SET UP WIRE
6200-7000 CMA; (1) 16 MAG
(1) 14 AWG
5200-6000 CMA; (2) 16 AWG
4000-5000 CMA; (1) 17 MAG
(1) 16 AWG
3000-3800 CMA; (2) 18 MAG
- 6 ATTACH ITEM 46 & 55 USING ITEM 94.

THIS DRAWING IS A CONTROLLED DOCUMENT. DIN M. YOUNGER 03APR2008

CHG: M. HERR

APPRO: T. ELBIN

PRODUCT SPEC: END FEED HDM APPLICATOR

APPLICATION SPEC: -

SIZE: A1

SCALE: 1:1

SHEET: 1 of 1

REV: A