

Apr.1.2017 Copyright 2017 HIROSE ELECTRIC CO., LTD. All Rights Reserved.

COUNT DESCRIPTION OF REVISIONS BY CHKD DATE				COUNT DESCRIPTION OF REVISIONS BY CHKD DATE			
△				△			
△				△			
△				△			

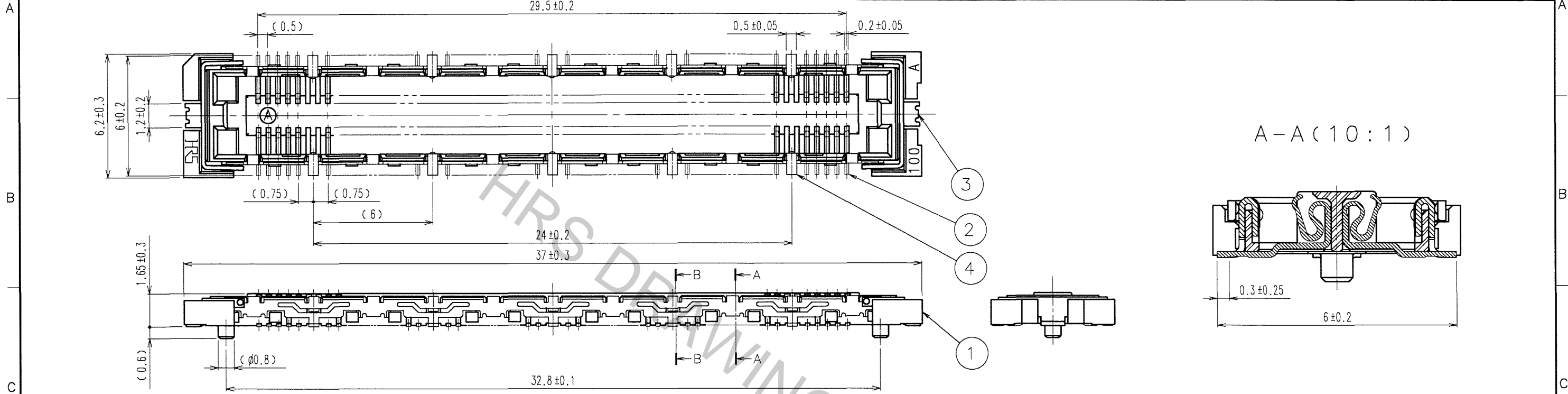

RECOMMENDED LAND PATTERN DIMENSION OF PCB

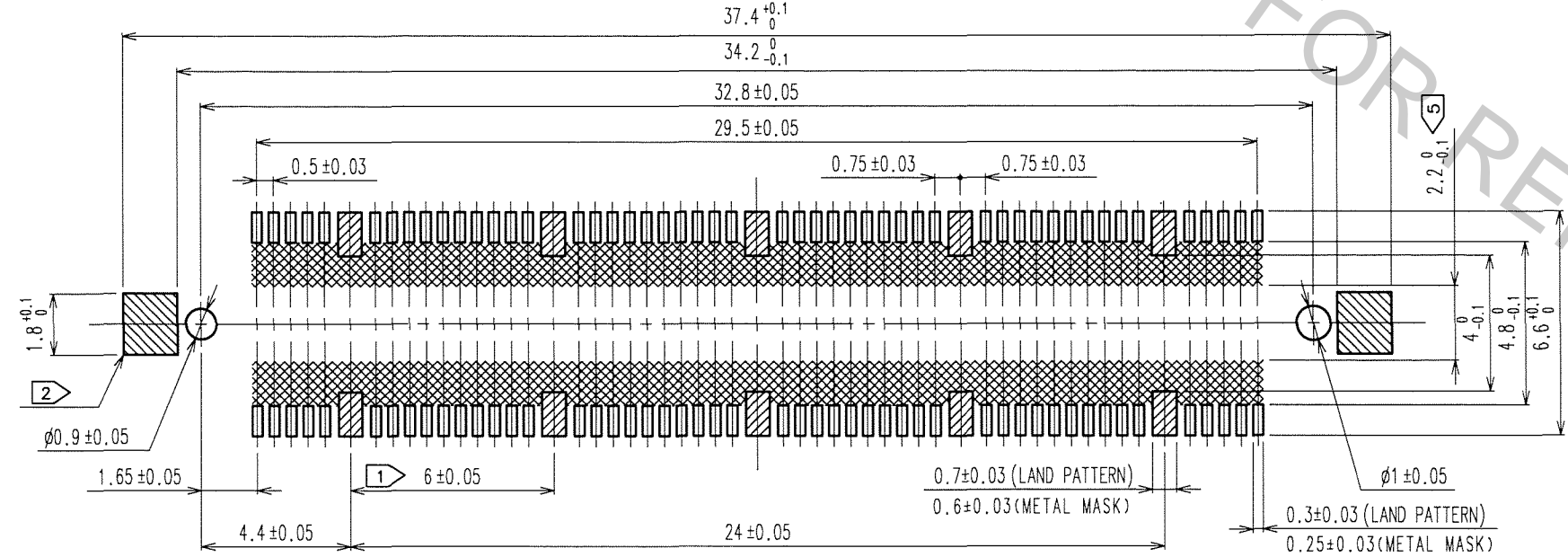

4	PHOSPHOR BRONZE	TIN PLATING
3	PHOSPHOR BRONZE	TIN PLATING
2	PHOSPHOR BRONZE	CONTACT AREA : GOLD 0.1μm min.
		LEAD AREA : GOLD FLASH
		UNDER PLATING : NICKEL 1μm min.

- NOTES
- ① 10 HATCHED PARTS:GROUND CIRCUIT.
 - ② 2 HATCHED PARTS:GROUND CIRCUIT.
 - ③ SMT LEAD-COPLANARITY:0.1 MAX.
 - ④ THIS PRODUCT HAS NO POLARITY TO PATTERN FOR MOUNTING.
 - ⑤ MAKE SURE WIDTH OF PATTERN IS WITHIN THAT OF LAND ,OR LEAD MAY TOUCH PATTERN.(THIS APPLIES TO HATCHED AREA.)
 - ⑥ TO BE EMBOSSED CARRIER TAPED AS SPECIFIED IN SHEET 2.
 - ⑦ THE DIMENSIONS IN PARENTHESES ARE FOR REFERENCE.

1	LCP	BEIGE	UL94V-0				
NO.	MATERIAL	FINISH, REMARKS		NO.	MATERIAL	FINISH, REMARKS	
	CL						
	CODE NO. (OLD)	DRAWN	DESIGNED	CHECKED	APPROVED	RELEASED	
		S.KAMIGA	<i>N. Nakamura</i>	<i>K. Ozawa</i>	<i>H. Okawa</i>		
		06.09.25	06.09.26	06.09.26	06.09.26		
	SCALE	DRAWING NO.		PART NO.			
	5 : 1	EDC3-152110-22		FX11LA-100S/10-SV(92)			
	UNITS	HIROSE ELECTRIC CO.,LTD.		CODE NO.		1/2	
	mm			CL573-0104-7-92			

TO
PCK

Apr.1.2017 Copyright 2017 HIROSE ELECTRIC CO., LTD. All Rights Reserved.

COUNT	DESCRIPTION OF REVISIONS	BY	CHKD	DATE	COUNT	DESCRIPTION OF REVISIONS	BY	CHKD	DATE

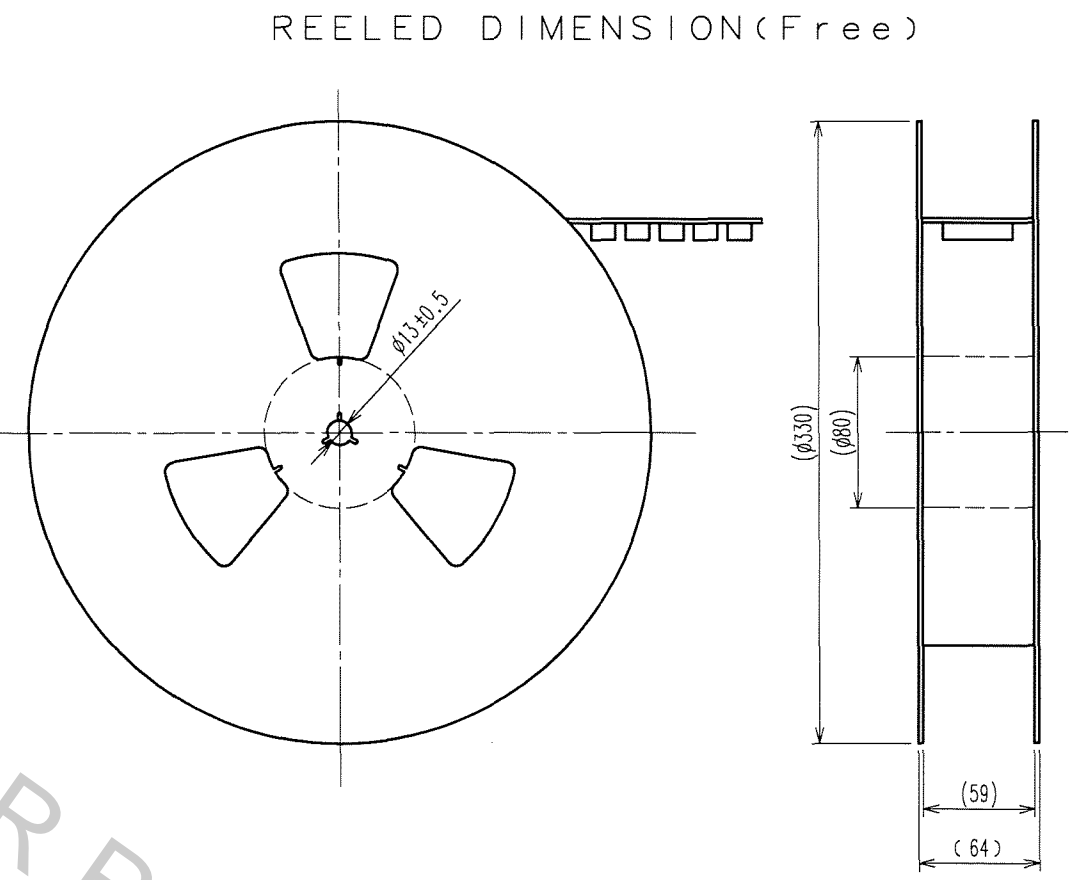
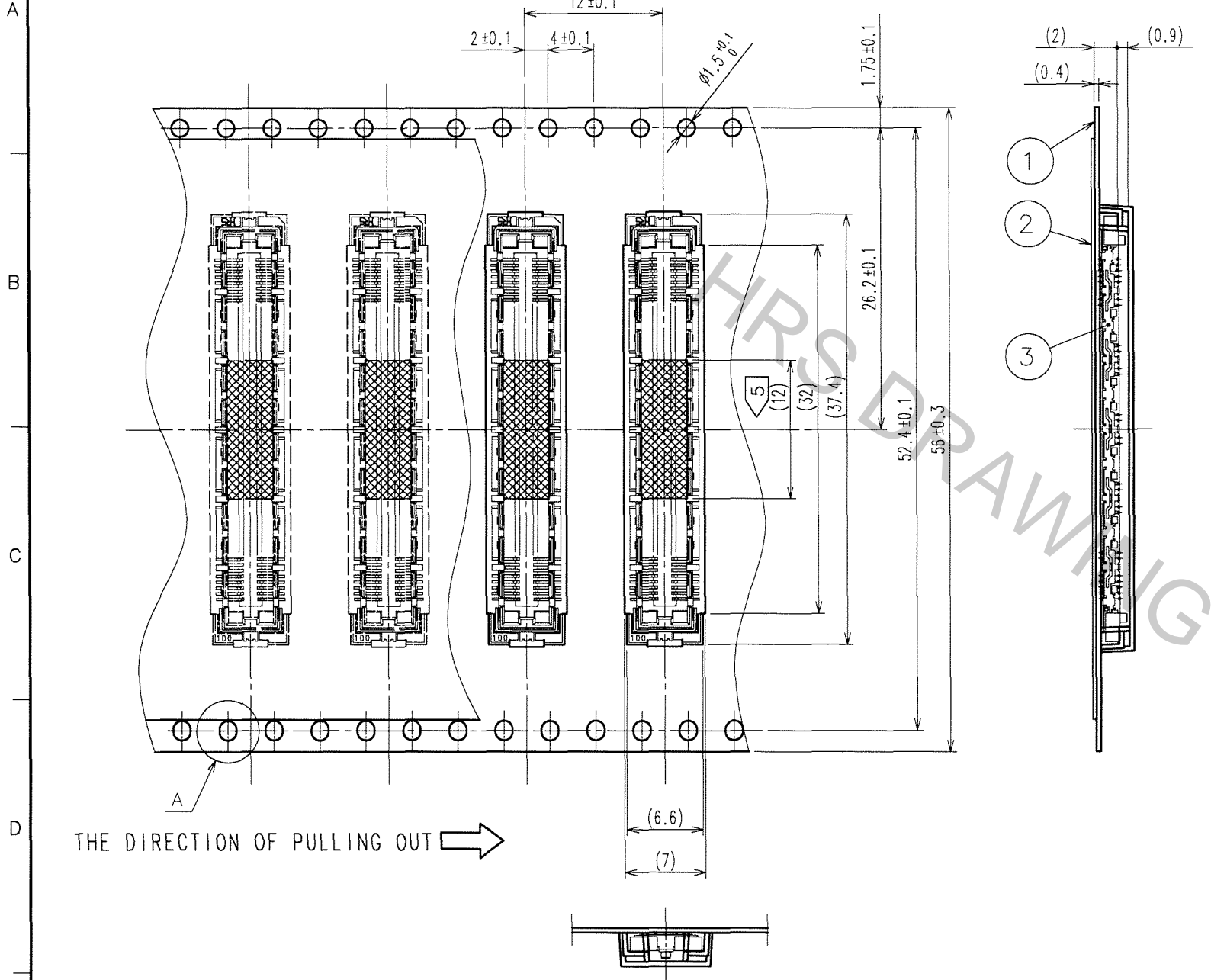

A (5:1)

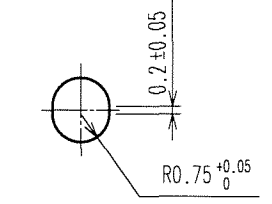

DETAIL FOR TAPE PICKUP (5:1)

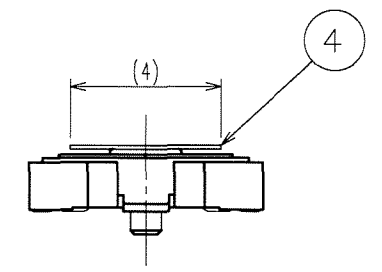

- NOTES
- 1 REEL:1000 CONNECTORS.
 - 2 MINIMUM 10 COMPARTMENTS FROM BOTH REEL ENDS REMAIN EMPTY.
 - 3 THIS PRODUCT HAS NO POLARITY TO TAPE AND REEL PACKAGING.
 - 4 THE DIMENSIONS IN PARENTHESES ARE FOR REFERENCE.
 - 5 REMOVE THE VACUUM PICKUP TAPE AFTER MOUNTING THE CONNECTOR.

TO
PCK

NO.	MATERIAL	FINISH, REMARKS	NO.	MATERIAL	FINISH, REMARKS
2	PET	(TOP COVER TAPE)	4	POLYIMIDE	(TAP FOR VACUUM PICKUP)
1	PS	(EMBOSSED CARRIER TAPE)	3		(CONNECTOR)

CODE NO. (OLD) CL	DRAWN S.KAMIGA 06.09.25	DESIGNED <i>M. Nakamura</i> 06.09.26	CHECKED <i>C. Ozawa</i> 06.09.26	APPROVED <i>H. Okawa</i> 06.09.26	RELEASED
DRAWING NO. EDC3-152110-22		PART NO. FX11LA-100S/10-SV(92)			
UNITS mm		CODE NO. CL573-0104-7-92			2