

Tous droits strictement reserves. Reproduction ou communication a des tiers interdite sous quelque forme que ce soit sans autorisation ecrite du proprietaire. Propriete de c FCI. Droits de reproduction FCI.

All rights strictly reserved. Reproduction or issue to third parties in any form whatever is not permitted without written authority from the proprietor. Property of FCI. Copyright FCI.

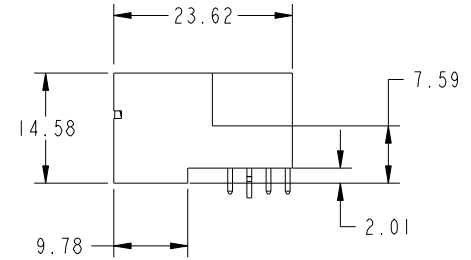
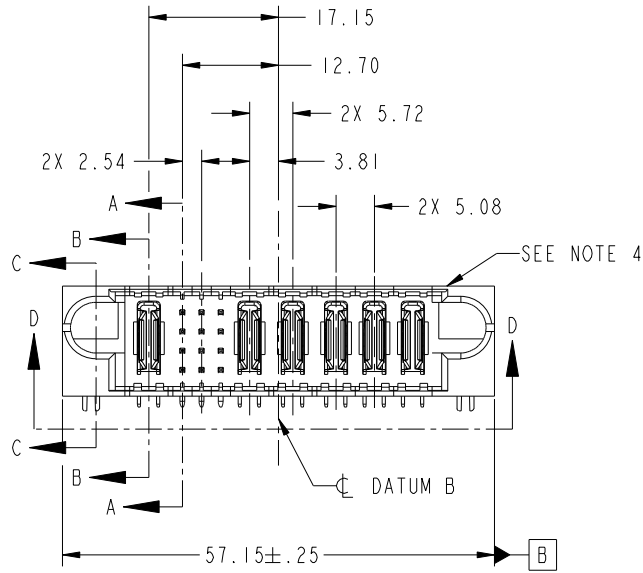
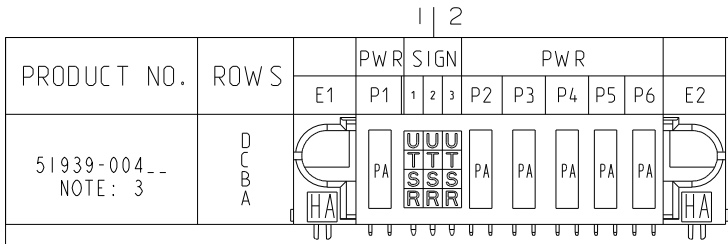

CODE	DIM "M" MATING LENGTH	CONTACT TYPE
R	[6.86]	SIGNAL
S	[6.86]	SIGNAL
T	[6.86]	SIGNAL
U	[6.86]	SIGNAL
PA	[N/A]	POWER
HA	[N/A]	HOLD-DOWN

mat'l code				SEE NOTE		tolerances unless otherwise specified	
ltr	ecn no.	dr	date	linear	angles		
A	V12793	JWS	12/12/01	0.X ± 0.5	0° ± 2°		
B	DG05-0240	GuoJM	07/26/05	0.XX ± 0.25			
C	DG06-0008	JMG	01/07/06	0.XXX ± 0.10			
D	DG08-0272	JW	09/27/08				
				engr	J. SHAFFER	12/12/01	
				chr	M. MOSTOLLER	12/12/01	
				appd	M. MOSTOLLER	12/12/01	
sheet index	revision sheet	D 1	D 2	D 3	D 4		

CUSTOMER	COPY	projection
MM	1:1	

		www.fciconnect.com	
title			
IP + 12S + 5P			
RIGHT ANGLE SOLDER HEADER			
product family		PwrBlade	
size	dwg no	code	
A	51939-004	213	
		sheet	
		1 of 4	

A

A

B

B

Tous droits strictement reserves. Reproduction ou communication a des tiers interdite sous quelque forme que ce soit sans autorisation ecrite du proprietaire. Propriete de c.FCI. Droits de reproduction FCI.

All rights strictly reserved. Reproduction or issue to third parties in any form whatever is not permitted without written authority from the proprietor. Property of FCI. Copyright FCI.



PRODUCT NUMBER

51939-004--
NOTE: 3

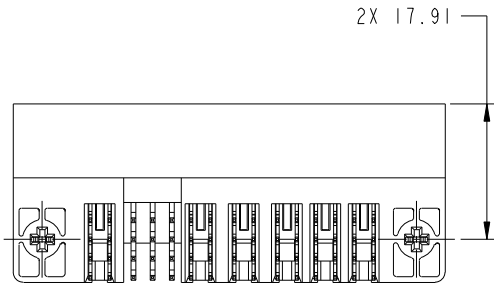

SECTION D-D

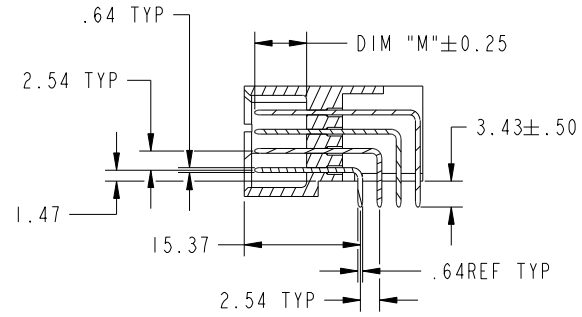

SECTION A-A

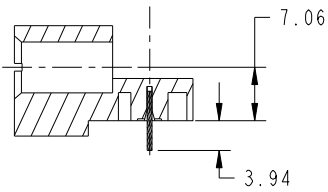

SECTION C-C

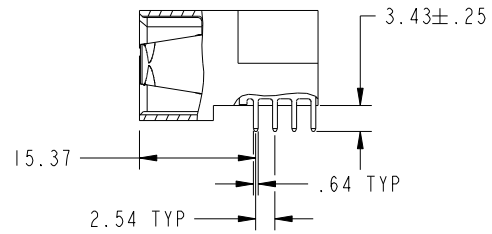

SECTION B-B

mat'l code		SEE NOTE		tolerances unless otherwise specified		CUSTOMER		 www.fciconnect.com	
lir	ecn no.	dr	date	linear	0.X ± 0.5	COPY		title	
D				linear	0.XX ± 0.25	projection		IP + 12S + 5P	
				linear	0.XXX ± 0.10			RIGHT ANGLE SOLDER HEADER	
				angles	0° ± 2°			product family	
				dr	J. SHAFFER 12/12/01	MM		PwrBlade	
				enrg	M. MOSTOLLER 12/12/01			code	
				chr	M. MOSTOLLER 12/12/01	1:1		213	
				appd	M. MOSTOLLER 12/12/01	A		51939-004	
sheet index		revision sheet						sheet	
								2	

Tous droits strictement réservés. Reproduction ou communication a des tiers interdite sous quelque forme que ce soit sans autorisation écrite du propriétaire. Propriété de c.FCI. Droits de reproduction FCI.

All rights strictly reserved. Reproduction or issue to third parties in any form whatever is not permitted without written authority from the proprietor. Property of FCI. Copyright FCI.



PRODUCT NUMBER

51939-004--
NOTE: 3

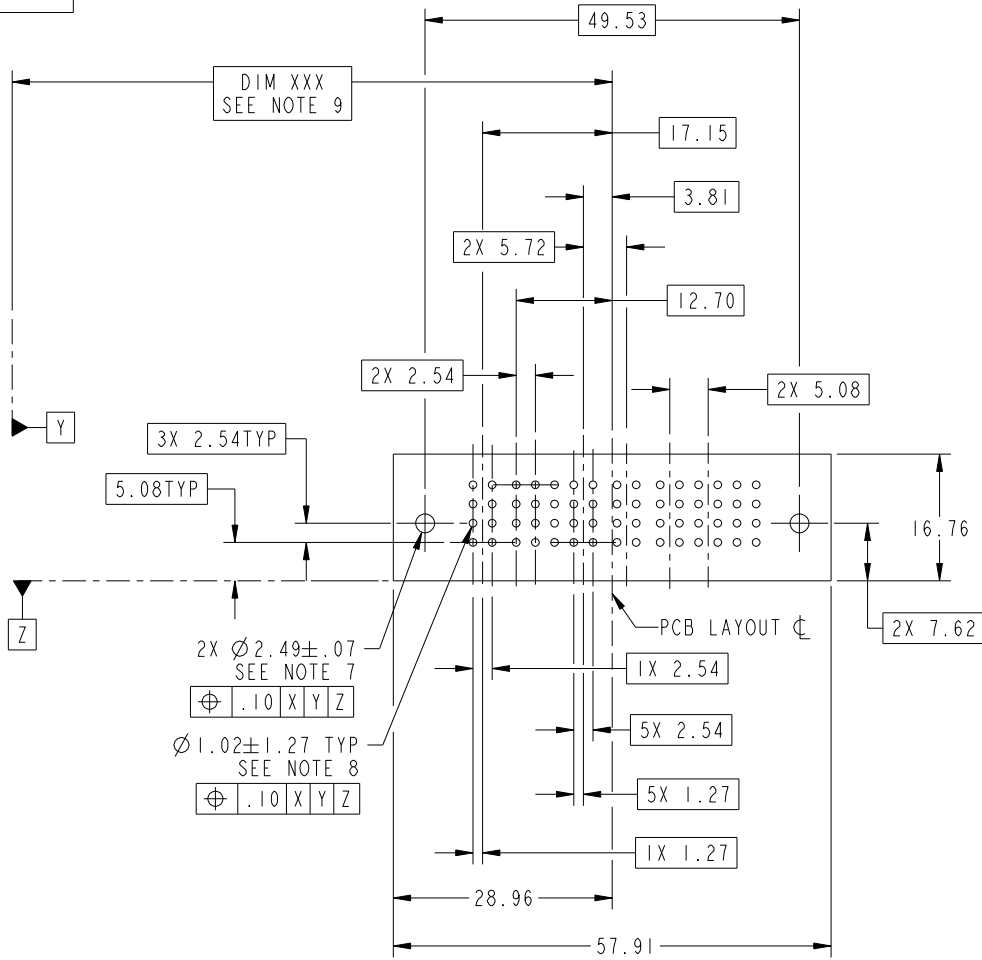

RECOMMENDED PCB LAYOUT

mat'l code		SEE NOTE		tolerances unless otherwise specified		CUSTOMER		 www.fciconnect.com	
lir	ecn no.	dr	date	linear	0.X ± 0.5		COPY		title IP + 12S + 5P RIGHT ANGLE SOLDER HEADER
D					0.XX ± 0.25		projection		
					0.XXX ± 0.10				
				angles	0° ± 2°		 MM		product family
				dr	J. SHAFFER	12/12/01	 1:1		PwrBlade
				enrg	M. MOSTOLLER	12/12/01	size	dwg no	code
				chr	M. MOSTOLLER	12/12/01	A	51939-004	213
				appd	M. MOSTOLLER	12/12/01			sheet
sheet index		revision sheet						3	

cage code 28506

Tous droits strictement réservés. Reproduction ou communication a des tiers interdite sous quelque forme que ce soit sans autorisation écrite du propriétaire. Propriété de c.FCI. Droits de reproduction FCI.

All rights strictly reserved. Reproduction or issue to third parties in any form whatever is not permitted without written authority from the proprietor. Property of FCI. Copyright FCI.



1 | 2

3

4

PRODUCT NUMBER
51939-004--
NOTE: 3

NOTES:

1. DIMENSIONS AND TOLERANCES ARE IN ACCORDANCE WITH ASME Y14.5M, 1994 UNLESS OTHERWISE SPECIFIED.

CONNECTORS NOTES:

2. HOUSING MATERIAL: UL 94 V-0 GLASS FILLED HIGH TEMP THERMO PLASTIC
POWER CONTACT MATERIAL: COPPER ALLOY
SIGNAL PIN MATERIAL: COPPER ALLOY

3. PLATING
SEE ITEM 1 & 2 IN PRINT 10064183 FOR PLATING SPEC OF 51939-004; 51939-004LF PRESPECTIVELY

4. "MANUFACTURER" NAME, P/N, AND DATE CODE TO APPEAR ON THIS SURFACE.

5. PRODUCT SPECIFICATION GS-12-149.

PCB - NOTES:

6. ALL HOLE DIAMETERS ARE FINISHED HOLE SIZE.

7. HOLD DOWN THROUGH HOLES ARE UNPLATED.

8. $\varnothing 1.151 \pm 0.025$ DRILLED HOLES PLATED WITH 0.008 MIN SnPb OR Sn OVER 0.03 TO 0.08 Cu PLATING TO ACHIEVE $\varnothing 1.02 \pm .07$ HOLE.

9. "DIM XXX" TO BE DETERMINED BY THE CUSTOMER.

10. SYMBOL WILL BE NEXT TO ANY DIMENSION, VIEW, OR NOTE WHICH HAS BEEN MODIFIED WITH THE CURRENT DRAWING REVISION.

A

A

B

B

mat'l code		SEE NOTE		tolerances unless otherwise specified		CUSTOMER				www.fciconnect.com	
lir	ecn no.	dr	date	linear	0.X ±0.5		COPY		title IP + 12S + 5P RIGHT ANGLE SOLDER HEADER		
D					0.XX ±0.25		projection				
					0.XXX ±0.10						
				angles	0° ±2°				product family PwrBlade code 213		
		dr	J. SHAFFER 12/12/01	engr	M. MOSTOLLER 12/12/01	scale		size A		dwg no 51939-004 sheet 4	
		chr	M. MOSTOLLER 12/12/01	appd	M. MOSTOLLER 12/12/01	1:1					
sheet index	revision sheet										

1 | 2

Pro/E

PDM: Rev:D

STATUS: Released

Printed: Dec 20, 2010

cage code 2856

4