

NOTES:

1. INSULATOR: GLASS FILLED POLYMER, U.L. 94 V-0, COLOR: BLACK. TERMINAL: PHOSPHOR BRONZE.
2. CONFORMS TO PRODUCT SPEC. 70928.
3. PART TO BE PACKAGED PER PK-70873-0603.

NOTE FOR LEAD FREE CONVERSION:

THE PRIMARY SHIPPING CARTON WILL BE LABELED "COMPLIANT TO ROHS DIRECTIVE 2002/95/EC AND ELV ANNEX II OF DIRECTIVE 2000/53/EC". CARTONS WITHOUT THIS LABEL MAY CONTAIN PRODUCT WITH LEAD.

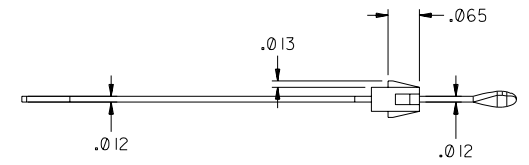
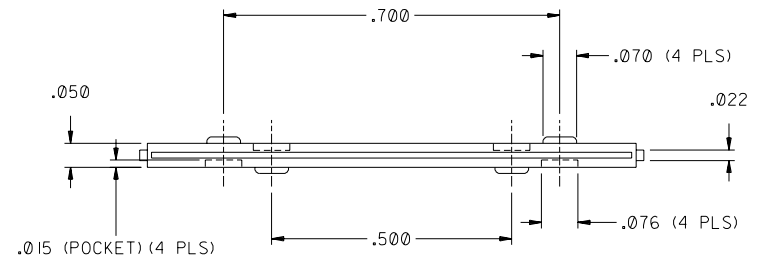
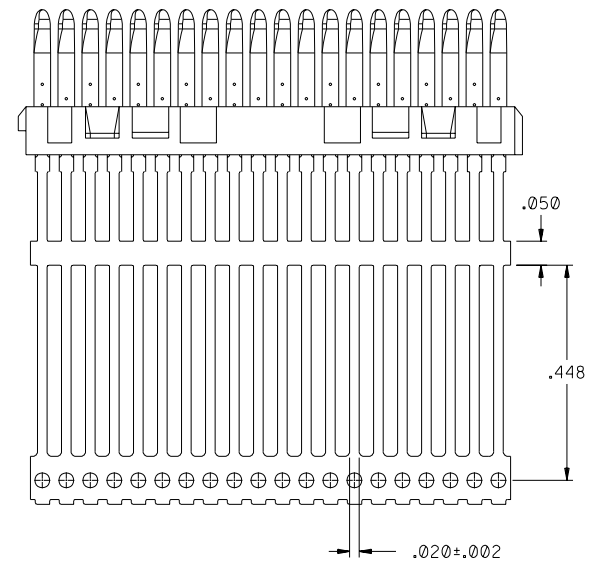
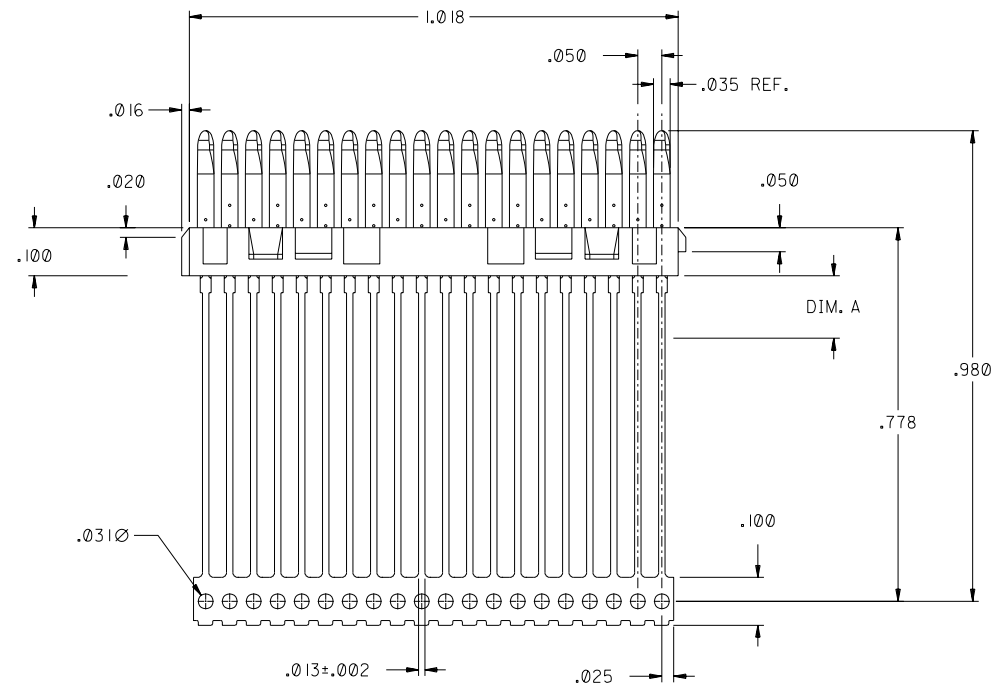

B	LEADFREE ECN# UCF2004-1998 DMORGAN 04/04/15
A	FIRST RELEASE PER ECN US-1116 DRS 05/15/95

71477-0011	N/A	YES	.000030/(0.00076) MINIMUM GOLD IN CONTACT AREA OVER NICKEL UNDERPLATE OVERALL.
71477-0003	.130±.010	NO	.000030/(0.00076) MINIMUM OF GOLD IN SELECTIVE AREA; .000100/(0.00254) MINIMUM OF TIN ON SELECTG AREA; NICKEL UNDERPLATE OVERALL.
71477-0002	N/A	NO	.000030/(0.00076) MINIMUM OF GOLD IN SELECTIVE AREA; .000100/(0.00254) MINIMUM OF TIN ON SELECTG AREA; NICKEL UNDERPLATE OVERALL.
ITEM NUMBER	DIM A	BUSBAR	PLATING

DIMENSIONS SHOWN (METRIC) INCH	
UNLESS OTHERWISE SPECIFIED TOLERANCES: ANGULAR ± 1/2°	
3 PLAGE ± .010	---
2 PLAGE ± ---	± ---
1 PLAGE ---	± ---
DRAFT WHERE APPLICABLE MUST REMAIN WITHIN DIMENSIONS	
DRWG. BY: SCHMIDGALL	CHK'D. BY: MOS
APP'D. BY: GWF	SCALE: 5 : 1

▽ = 0	▼ = 0	REVISE ONLY ON CAD SYSTEM
TITLE: STICKS FOR 80 CKT LFH CABLE ASSEMBLIES SALES DRAWING		
MOLEX INCORPORATED	SHEET NO. 1 OF 1	DATE 05/15/95
SEE CHART SDA-71477-*****		
FILE NAME: S71477X1.DGN	THIS DRAWING CONTAINS INFORMATION THAT IS PROPRIETARY TO MOLEX INC. AND SHOULD NOT BE USED WITHOUT WRITTEN PERMISSION.	CD C