

Technical specification :

Rated voltage: IEC 61076-2-104	30 V
Current rating: IEC 61076-2-104	3 A at 40°C
Insulation resistance: IEC 60512	>=100 MΩ
Pollution degree: IEC 60664-1	3/2
Degree of protection: IEC 60529	IP 67, in mated condition
Temperature range: IEC 60664-1	-30°C ... +80°C
Mating cycles: IEC 60512-9a	>=100

Materials:

Contact:	CuZn
Contact plating:	Nickel, gold plated
Contact carrier:	TPU GF, UL 94
Moulding body:	TPU, UL 94, grey

Contact assignment:

- 1) brown _____
- 2) white _____
- 3) blue _____
- 4) black _____

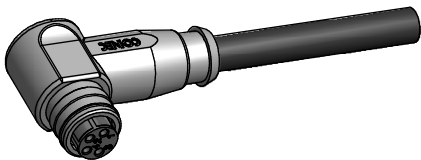

Part no:	Description:	Length L:	Cable:
42-10116	SAL - 8 - RKWS4 - 2 / K1	2m	TPU, UL 20549, black, 4x0,25mm ² Cable: 781-K12400
42-10117	SAL - 8 - RKWS4 - 3 / K1	3m	
42-10118	SAL - 8 - RKWS4 - 5 / K1	5m	
42-10119	SAL - 8 - RKWS4 - 10 / K1	10m	
42-xxxxx	SAL - 8 - RKWS4 - ... / K1	x	

D see data sheet cable

DO NOT ALTER CAD DRAWING BY HAND Directive 2002/95/EC RoHS compliant	Index: a 15.03.2011 VF Ä3941 data sheet revised		dim. in mm		title: Female connector M8x1 angled snap	
			date	name		
	tolerance of cable: L ≤ 4m: L + 40mm L > 4m: L + 1%		drawn	10.10.07	Franz	dwg no: 42K1A033
	general tolerance: 0 ± 0,50mm 0,0 ± 0,25mm 0,00 ± 0,10mm		appd.	10.10.07	Mankopf	
	THIS DRAWING MAY NOT BE COPIED OR REPRODUCED IN ANY WAY, AND MAY NOT BE PASSED ON TO A THIRD PARTY WITHOUT WRITTEN PERMISSION. OWNERSHIP AND COPYRIGHT OF CONEC GmbH				part no: see table	