

Apr.1.2017 Copyright 2017 HIROSE ELECTRIC CO., LTD. All Rights Reserved.

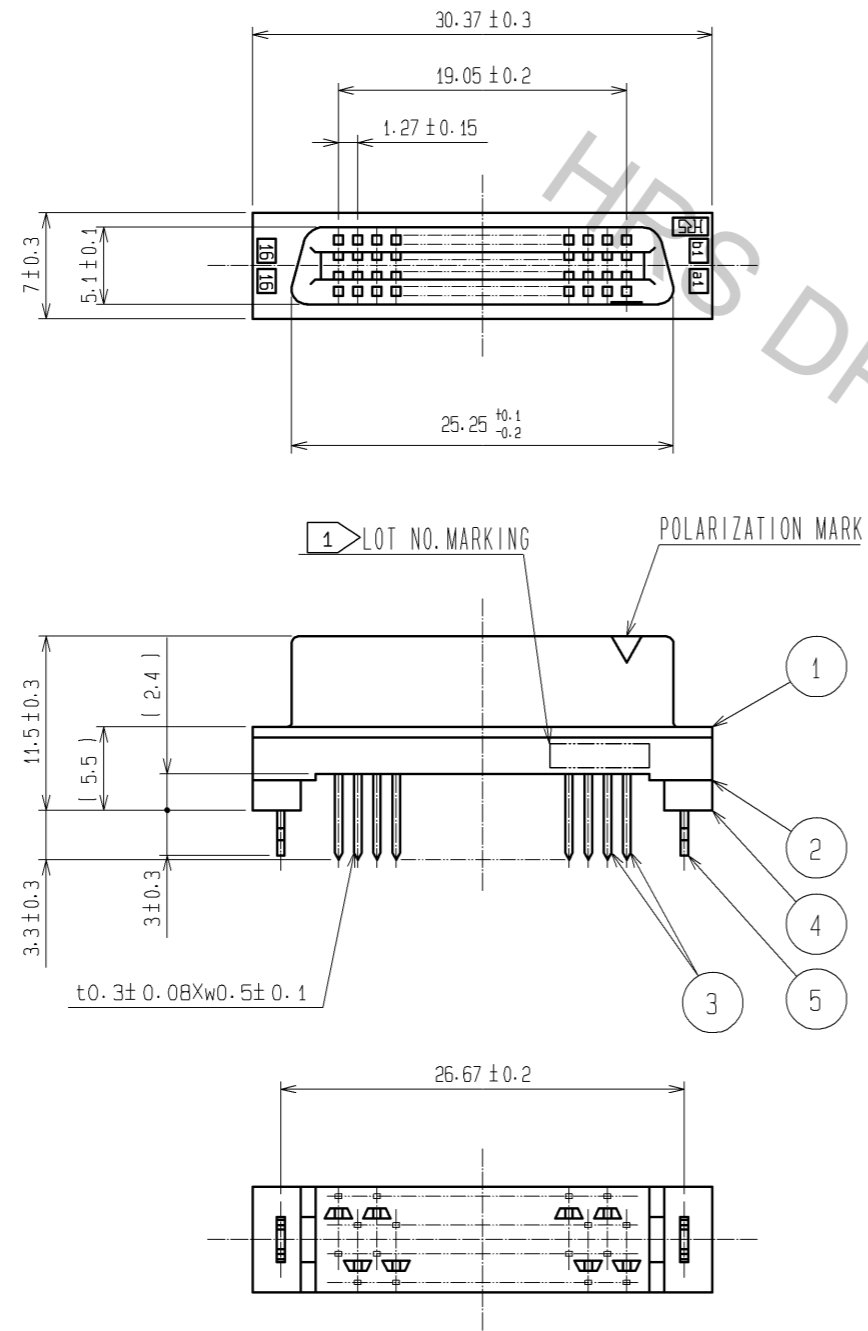

RECOMMENDED PC BOARD HOLE PATTERN (MOUNTING SIDE)

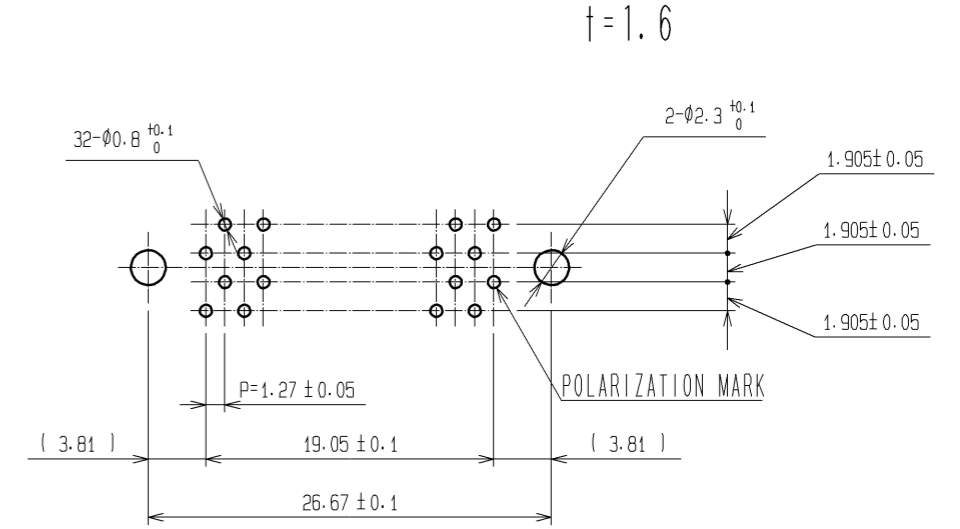

- NOTES
- LOT NO. MARKING SIDE SHALL BE OPTIONAL.
 - THE DIMENSIONS IN PARENTHESES ARE FOR REFERENCE.

5	PHOSPHOR BRONZE	TIN-PLATING	3	PHOSPHOR BRONZE	CONTACT AREA : GOLD 0.2μm min. DIP AREA : TIN-PLATING 2μm min. UNDER PLATING : NICKEL 2μm min.			
1, 2, 4	POLYAMIDE	BLACK , UL94V-0						
NO.	MATERIAL	FINISH , REMARKS	NO.	MATERIAL	FINISH , REMARKS			
UNITS mm		SCALE 2 : 1		COUNT	DESCRIPTION OF REVISIONS	DESIGNED	CHECKED	DATE
HRS HIROSE ELECTRIC CO., LTD.		APPROVED : HS. OKAWA 07.08.22	DRAWING NO. EDC3-083220-21					
		CHECED : HS. OZAWA 07.08.22	PART NO. FX2C2-32S-1.27DSAL(71)					
		DESIGNED : KY. NAKAMURA 07.08.22	CODE NO. CL572-2472-5-71					
		DRAWN : TP. MATSUMOTO 07.08.10						