

THIS DRAWING IS UNPUBLISHED. RELEASED FOR PUBLICATION, 19 .
 © COPYRIGHT 19 BY AMP INCORPORATED. ALL INTERNATIONAL RIGHTS RESERVED.

LOC	DIST	P	F	ZONE	LTR	DESCRIPTION	DATE	APPD
BD	95				O	RELEASED PER NPR 2244, WAS 88-5870-28	11/30/88	-
					A	REVISED PER ECN#4221-437	04/12/89	JAR
					B	REVISED PER ECN 4221-0453	10/30/89	MAM
					C	REVISED PER ECN 4221-0586	7-5-90	-
					D	REV PER EC 0640-232-99	11 MAY 99	DR

CABLE SUPPLIED BY CUSTOMER 1

STRAIN RELIEF STAPLE (1 SUPPLIED)
 MATERIAL: STEEL
 PLATING: BRIGHT TIN/LEAD OVER NICKEL

32.77
[1.290]

MACHINE SCREW (2 SUPPLIED)
 #2-56 UNC X 6.35 [.250]

SPRING LATCH (2 SUPPLIED)
 MATERIAL: STAINLESS STEEL

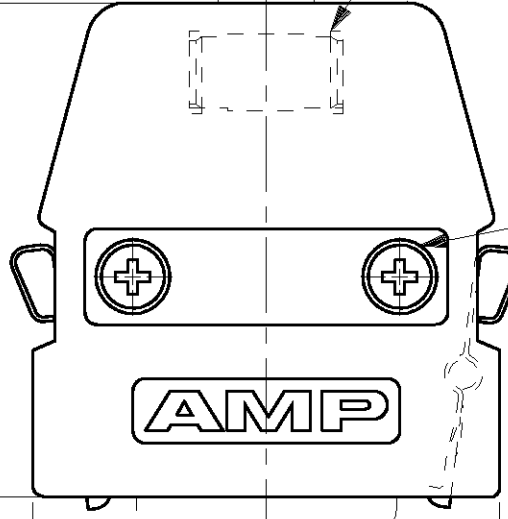

30.86
[1.215]

CONNECTOR (MUST BE PURCHASED SEPARATELY)

UPPER BACKSHELL (1 SUPPLIED)
 MATERIAL: ZINC
 PLATING: NICKEL OVER COPPER

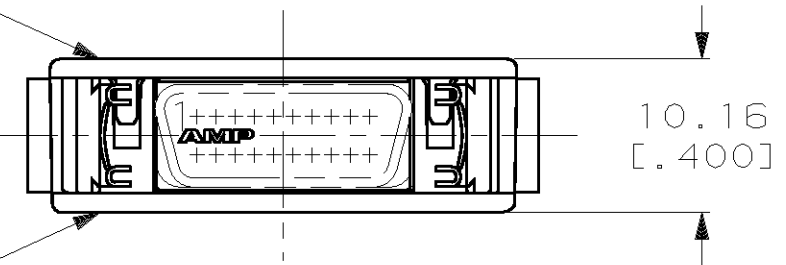

10.16
[.400]

LOWER BACKSHELL (1 SUPPLIED)
 MATERIAL: ZINC
 PLATING: NICKEL OVER COPPER

1 6.86 [.270] MAX CABLE DIA

DO NOT SCALE PRINT. UNLESS SPECIFIED DIMENSIONS IN mm [INCHES] TOLERANCES ON:		DR 12-20-88 M.A.McCAFFREY	AS SHOWN	749190-1
2 PLC DEC ± -		CHK 12-20-88 M.E.SHIRK	REMARKS	PART NO
3 PLC DEC ± 0.38 [.015]		APPD 12-20-88 J.BROSCHARD	AMP INCORPORATED Harrisburg, Pa. 17105	
ANGLES ± -		APPD 12-20-88 C.E.REYNOLDS		
MATERIAL	-	PRODUCT SPEC	NAME INDIVIDUAL KIT, UNASSEMBLED, 20 POSITION, STRAIGHT EXIT, UNKEYED, AMPLIMITE .050 Series	
FINISH	-	APPLICATION SPEC	SIZE B	FSCM NO 00779
		WEIGHT -	DRAWING NO 749190	
			SCALE 2:1	SHEET 1 OF 1