

**Contact assignment:**

- |            |                |
|------------|----------------|
| 1 - brown  | 7 - black      |
| 2 - blue   | 8 - grey       |
| 3 - white  | 9 - red        |
| 4 - green  | 10 - violet    |
| 5 - pink   | 11 - grey-pink |
| 6 - yellow | 12 - red-blue  |

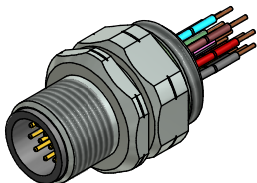

**Technical specification :**

Rated voltage: IEC 61076-2-101	30 V
Current rating: IEC 61076-2-101	1,5 A at 40°C
Insulation resistance: IEC 60512	>=100 MΩ
Pollution degree: IEC 60664-1	3/2
Degree of protection: IEC 60529	IP 67, in mated condition
Temperature range:	-30°C ... +80°C
Mating cycles: IEC 60512-9a	>=100

**Materials:**

Contact:	CuZn
Contact plating:	Nickel, gold plated
Contact carrier:	PBT GF, UL 94
Sealing:	FPM
Counter nut:	CuZn, nickel plated
Socket housing:	CuZn, nickel plated
Grouting:	Polyurethane-resin, UL 94

**Installation specification:**

recommended torque:	1-1,2 Nm
Conec installation tool:	Torque wrench: 36-000200 Insert across flats 17: 36-000230

Part no:	Description:	Pos	Length L:	Wire:
43-01348	SAL - 12 - FSP12 - 0,5 - 9	12	0,5m	AWG 26 PVC, UL
43-xxxxx	SAL - 12 - FSP12 - ... - 9	12	x	

DO NOT ALTER CAD DRAWING BY HAND Directive 2002/95/EC RoHS compliant	Index: b 15.02.13 MG Ä4631 Data sheet revised, technical specification changed, materials corrected	dim. in mm	title: <b>Male connector M12x1 with wire, frontmounting, reposition, PG9</b>										
	tolerance of wire: L ≤ 0,5m: L + 20mm L > 0,5m: L + 4%		<table border="1"> <tr> <td></td> <td>date</td> <td>name</td> </tr> <tr> <td>drawn</td> <td>21.10.08</td> <td>Fromm</td> </tr> <tr> <td>appd.</td> <td>21.10.08</td> <td>Mankopf</td> </tr> </table>		date	name	drawn	21.10.08	Fromm	appd.	21.10.08	Mankopf	dwg no: <b>43K1A780</b>
		date	name										
	drawn	21.10.08	Fromm										
appd.	21.10.08	Mankopf											
general tolerance: 0 ± 0,50mm 0,0 ± 0,25mm 0,00 ± 0,10mm		part no: see table											
<small>THIS DRAWING MAY NOT BE COPIED OR REPRODUCED IN ANY WAY, AND MAY NOT BE PASSED ON TO A THIRD PARTY WITHOUT WRITTEN PERMISSION. OWNERSHIP AND COPYRIGHT OF CONEC GmbH</small>													