

PART NUMBER	REV	FIRST USED	TERMINATOR	FEED TYPE	DESCRIPTION
1426239-1	B	-	LEADMAKER	MECH POST FEED	CUTS CARRIER
1426239-2	B	-	BENCH	MECH PRE FEED	CUTS CARRIER
1426239-6	B	-	LEADMAKER	MECH POST FEED	CONTINUOUS CARRIER
7-1426239-1	B	-	LEADMAKER	MECH POST FEED	-1 AND SPARE PARTS
7-1426239-2	B	-	BENCH	MECH PRE FEED	-2 AND SPARE PARTS
7-1426239-6	B	-	LEADMAKER	MECH POST FEED	-6 AND SPARE PARTS
7-1426239-7	A	-	-	-	SPARE PARTS KIT

CRIMP DATA DELPHI TERMINAL DELPHI CRIMP SPECS

TERMINAL NAME: DELPHI REC. CONTACT

CRIMP	SIZE	TYPE	RANGE
WIRE	2.54 [.100 IN]	F	1.00-2.00mm ²
INSUL	4.83 [.190 IN]	0	1.90-2.60 [.075-.102 IN]
WIRE STRIP LENGTH	4.60 [.181 IN]		APPL INSTRUCTION 408-8322

TERMINAL	FEED
APPL SPEC 114-3118	15.25 [.600 IN]

TERMINALS APPLIED

AMP PN	MFR PN	SEAL	MFR PN
286998-1	413170	286965-1	12015323
-	-	286965-2	15363980
-	-	286965-3	15338470

WIRE SIZE	CRIMP HEIGHT	PIN PN AND LENGTH [IN]
2.00mm ²	1.90 ±0.05 [.075 ±.002 IN]	8-354778-0 [.2895]
1.50mm ²	1.80 ±0.05 [.071 ±.002 IN]	8-354778-8 [.2935]
1.00mm ²	1.70 ±0.05 [.067 ±.002 IN]	9-354778-6 [.2975]

- 1 RECOMMENDED SPARE PARTS.
- 2. GREASE RAM, CAM, CAM FOLLOWER AND FEED ROD LIGHTLY.
- 3. LUBRICATE DAILY PER THE APPLICATOR INSTRUCTION SHEET SUPPLIED WITH THE APPLICATOR.
- 4 THIS APPLICATOR APPLIES TERMINAL WITH A SEAL, INSULATION DIAMETER DEPENDENT UPON SEAL BEING APPLIED. SEAL RANGES FOR REFERENCE:-
PART NUMBER 286965-1 RANGE 2.03 - 2.85mm
286965-2 2.00 - 2.90mm
286965-3 1.60 - 2.40mm
- 5 APPLY TORQ-SEAL IN ALLEN SOCKET TO FILL HOLE AFTER FLAT HD HAS BEEN ADJUSTED TO CORRECT HEIGHT AT QUALIFICATION. APPLY #1-23419-5 LOC-TITE TO THREADS.
- 6 THE FOLLOWING PULL-OUT FORCES TAKE PRECEDENCE TO THOSE STATED IN 114-3118;
2.00mm² = 230N
1.50mm² = 200N
1.00mm² = 160N
- 7 INSULATION CRIMP HEIGHT REQUIREMENTS:-
2.00mm² 5.00 ± 0.10
1.50mm² 4.90 ± 0.10
1.00mm² 4.80 ± 0.10

VIEW B ROTATED 180°

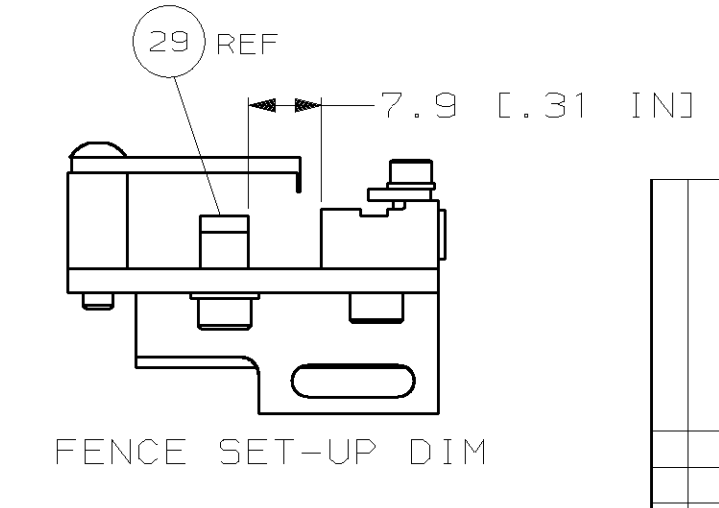
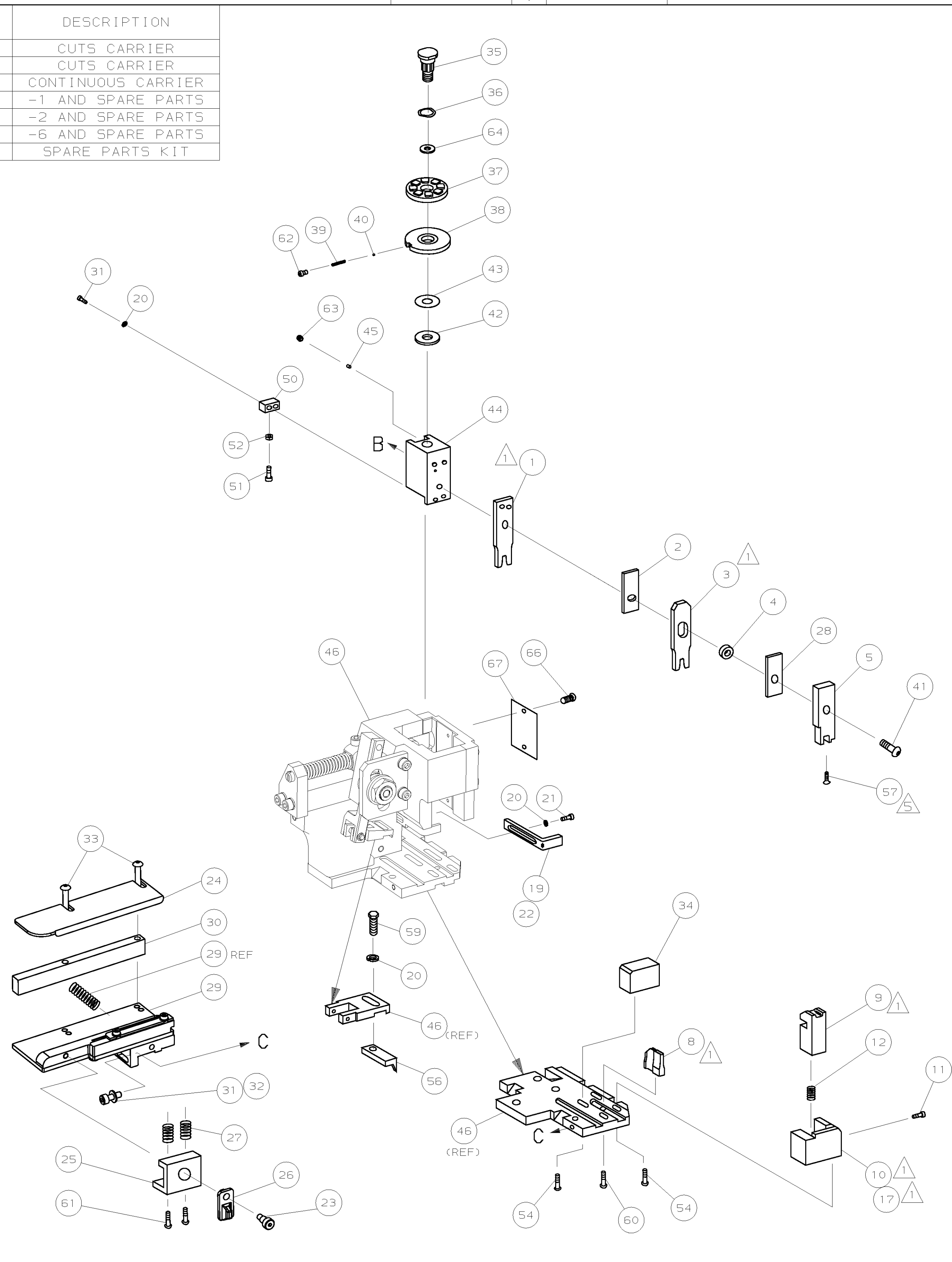
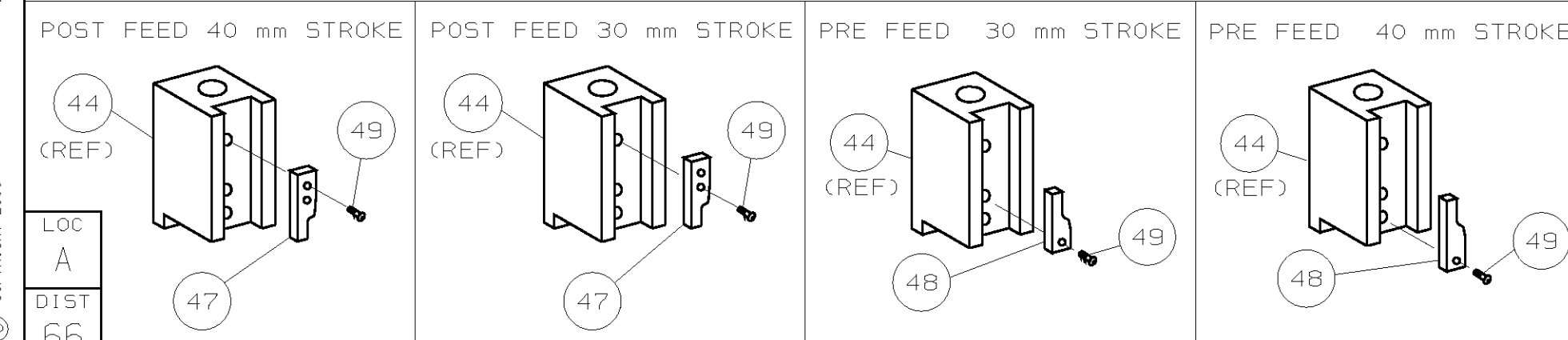

QTY	REQD PER ASSY	PART NO	DESCRIPTION	ITEM NO				
-	1	1	1	1	1	1426239	PRINT, APPLICATOR LOG SHEET	73
-	1	1	1	1	1	1338705-1	DOCUMENTATION PACKAGE	71
-	-	-	-	-	-	-	-	70
-	-	-	-	-	-	-	-	69
-	-	-	-	-	-	-	-	68
-	1	1	1	1	1	461264-1	PLATE, IDENTIFICATION	67
-	2	2	2	2	2	21017-2	SCR,DRIVE (#2x.19) ID PLATE	66
-	-	-	-	-	-	-	-	65
-	1	1	1	1	1	986950-1	WASHER, FLAT PRECISION	64
-	1	1	1	1	1	3-18031-0	SCR,SKT SET (M6X6)RAM	63
-	1	1	1	1	1	18023-9	SCR,SHC (M4X6) INS DISC	62
-	2	2	2	2	2	1-18024-5	SCR,BHC (M5X25)DRAG	61
-	1	1	1	1	1	18024-7	SCR,BHC (M4X10)ANVIL	60
-	1	1	1	1	1	5-18022-2	SCR,HEX (M4X8)FEED FINGER	59
-	-	-	-	-	-	-	-	58
-	1	1	1	1	1	985575-3	SCR,FHC (M3X10)DEP	57
-	1	1	1	1	1	1338685-1	PAWL, FEED	56
-	-	-	-	-	-	-	-	55
-	4	4	4	4	4	18024-8	SCR,BHC (M4X12) SHEAR HOLDER	54
-	-	-	-	-	-	-	-	53
-	1	1	1	1	1	18030-1	NUT, HEX (M3) HOLD DOWN	52
-	1	1	1	1	1	811242-5	BUMPER, HOLDDOWN	51
-	1	1	1	1	1	690753-2	SPACER, TONKER	50
-	1	1	1	1	1	18024-3	SCR,BHC (M3X10) CAM	49
-	-	-	-	-	-	-	-	48
-	1	-	1	-	1	1338676-1	CAM, POST FEED 30 & 40 mm ST	47
-	1	1	1	1	1	1320999-3	APPLICATOR BASIC SUBASSY	46
-	1	1	1	1	1	690191-1	PLUG, NYLON	45
-	1	1	1	1	1	1338660-1	RAM	44
-	1	1	1	1	1	690125-1	WASHER, LAMINATED	43
-	1	1	1	1	1	690124-1	WASHER, RAM	42
-	1	1	1	1	1	2-18024-6	SCR,BHC (M8X25)RAM	41
-	1	1	1	1	1	23241-1	BALL, STEEL	40
-	1	1	1	1	1	2-22278-7	SPRING, COMPRESSION	39
-	1	1	1	1	1	1320922-1	DISC, INSULATION	38
-	1	1	1	1	1	354777-1	WIRE DISC, PLASTIC	37
-	1	1	1	1	1	22480-5	WASHER, SPRING	36
-	1	1	1	1	1	690212-1	POST, RAM	35
-	1	1	1	1	1	1320934-1	SUPPORT, TERMINAL	34
-	2	2	2	2	2	1-18024-0	SCR,BHC (M4X20) STRIP GUIDE	33
-	1	1	1	1	1	18027-2	WASHER, FLAT (M4)	32
-	3	3	3	3	3	1-18023-2	SCR,SKT CAP (M4X12)MOUNT BLOCK	31
-	1	1	1	1	1	1320908-6	SPACER, STRIP GUIDE	30
-	1	1	1	1	1	1633073-1	STRIP GUIDE PLATE ASSY	29
-	1	1	1	1	1	455888-4	SPACER, FRONT SHEAR DEP	28
-	2	2	2	2	2	1-22284-0	SPRING, DRAG	27
-	1	1	1	1	1	356835-1	LEVER, DRAG RELEASE	26
-	1	1	1	1	1	240792-1	DRAG, TERMINAL	25
-	1	1	1	1	1	1320928-1	PLATE, STRIP GUIDE	24
-	1	1	1	1	1	980371-4	SCR,SHC SHLD	23
-	1	-	1	-	1	690472-2	STRIPPER	22
-	1	1	1	1	1	1-18023-1	SCR,SHC (M4X10) STRIPPER	21
-	4	4	4	4	4	18025-2	WASHER, LOCK (M4) STRIPPER	20
-	-	1	-	-	1	690472-1	STRIPPER	19
-	-	-	-	-	-	-	-	18
-	1	-	-	1	-	1338684-2	HOLDER, SHEAR, FRONT (NO-CUT)	17
-	-	-	-	-	-	-	-	16
-	-	-	-	-	-	-	-	15
-	-	-	-	-	-	-	-	14
-	-	-	-	-	-	-	-	13
-	1	1	1	1	1	5-22280-0	SPRING, SHEAR	12
-	1	1	1	1	1	356885-5	STOP, SHEAR	11
-	-	1	1	-	1	1-1320921-0	HOLDER, SHEAR, FRONT (CUT)	10
-	1	1	1	1	1	318707-2	SHEAR, FLOAT (FRONT)	9
-	1	2	2	2	2	1333206-9	ANVIL	8
-	-	-	-	-	-	-	-	7
-	-	-	-	-	-	-	-	6
-	1	1	1	1	1	1338680-3	DEPRESSOR, SHEAR (FRONT)	5
-	1	1	1	1	1	238011-2	SPACER, BLOCK CRIMPER	4
-	1	2	2	2	2	9-456135-4	CRIMPER, INSULATION	3
-	1	1	1	1	1	455888-9	SPACER, CRIMPER	2
-	1	2	2	2	2	456407-5	CRIMPER, WIRE	1

REVISION OF EACH ASSY NO (WHEN BLANK, USE DWG REVISION)

REV	DESCRIPTION	DATE				
-77	-76	-72	-71	-6	-2	-1

DR M. CLIFFORD 20AUG01 APP F. BACKHURST 20AUG01
CHK - REL 02OCT01 L. LOFHOUSE

AMP AMP Incorporated Harrisburg, PA 17105-3608

NAME: **SIDE FEED HD-I APPLICATOR** MACHINE REF: **HD-I APPL**

SCALE: **D** DWG NO: **1426239** SHEET: **1 OF 1** REV: **B**

CASE CODE: **00779** CUSTOMER AND ASSEMBLY DRAWING

THIS DRAWING IS A CONTROLLED DOCUMENT.

LAYOUT L1426239

SET UP GAGE 458637-3

2000 RELEASED FOR PUBLICATION BY AMP INCORPORATED. ALL RIGHTS RESERVED.

THIS DRAWING IS UNRELEASED. COPYRIGHT 2000