

## SUMMARY

### # Wires

Low	68
High	0
Coax	0
Triax	0
Quad	0
Fiber	0
Fluidic	0

Series LM

Termination type

IP rating 68

Cable Ø 11.35 - 22.70 mm

Matching parts HEW.LM.368.XLNP

Status

Alternative part



*Image is for illustrative purpose only*

### Download

[Request a quote](#)

[Catalog](#)

## TECHNICAL DETAILS

### Mechanics

Shell Style/Model FM\*: Straight plug, key (N) or keys (P, R, S, T, U, V, W and X) with knurled grip and mold stop

Keying

Housing Material Environment friendly aluminium (nickel plated, anthracite color) shell and nut, other pieces bronze/brass

Cable Fixing  $\varnothing$  11.35 - 22.7 mm

Variant

### Performance

Configuration

Insulator

Rated Current 2.5 Amps

### Specifications

Contact Type: Crimp

Max. Matings: 5000

Contact Retention: 22 N

Contact Dia.: 0.7 mm (0.028in)

Bucket Dia.: 0.45 mm (0.018in)  
 Min. Conductor: 0.035 mm<sup>2</sup> (AWG 32)  
 Max. Conductor: 0.09 mm<sup>2</sup> (AWG 28)  
 R (max): 6.1 mOhm  
 Test voltage (kV rms) Contact-contact: 1.40  
 Test voltage (kV rms) Contact-shell: 1.65

## Others

Humidity (max): <=95% [at 60 deg C / 140 F]  
 Vibration: 15 g [10 Hz - 2000 Hz]  
 Shock Resistance: 100 g [ 6 ms]  
 Operating temperature: -55°C / +200°C  
 Climatical Category: 15/200/21 (Al. shell)  
 Lighting strike EIA 364-75 10K amps - 6 times  
 EMI Shielding EIA 364-66A - 1Ghz-80 dB,3GHz-70 dB,6GHz- 58dB  
 IP Rating: 68

## DRAWINGS

### Draws

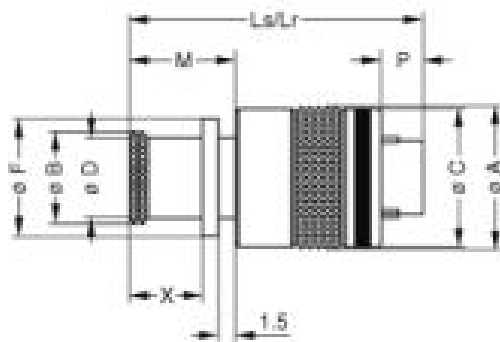

### Dimensions

	A	B	C	D	F	Lr	Ls	M	P	X
mm.	28.5	23.9	28	22.7	25.8	31.6	31.6	10.6	3.4	7.6
in.	1,12	0,94	1,10	0,89	1,02	1,24	1,24	0,42	0,13	0,30

## RECOMMENDED BY LEMO

### Tools

Crimp Tool: DPC.91.701.V

Crimp settings: AWG/Selector = 28-30-32/4-3-3  
Positionner: DCE.91.070.5MVC  
Extractor: DCF.93.070.4LT  
Replacement contact: FGN.0M.556.ZZC

## Cables