

THIS DOCUMENT IS SUBJECT TO CHANGE WITHOUT NOTICE. IT IS CONFIDENTIAL AND A PROPERTY OF AMPHENOL LTW. DISCLOSURE TO THIRD PARTY HAS TO BE AUTHORIZED BY AMPHENOL LTW.

| | | | | |
|------|---------|------|------|-------------|
| REV. | ECN NO. | DATE | SIGN | DESCRIPTION |
| | | | | |

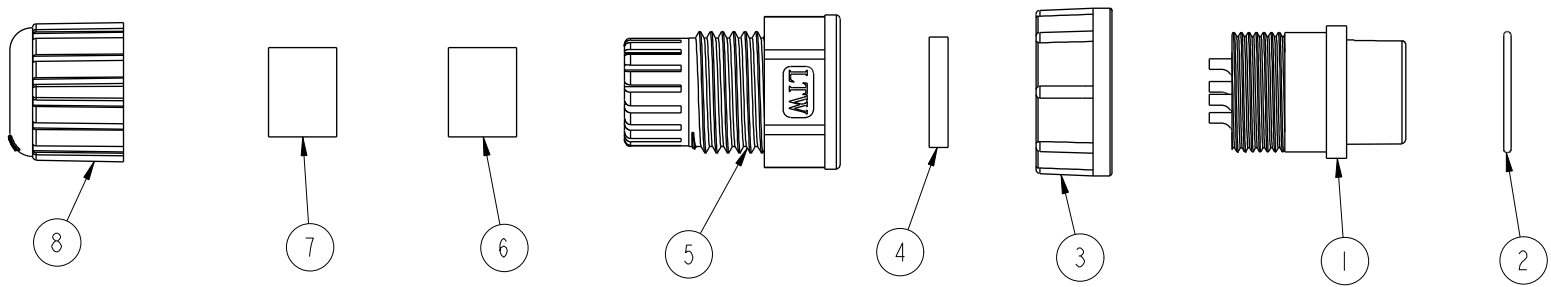

ALTW
 DCC. DEPT.
 CONFIDENTIAL
 2012-04-26

ISSUED

ALTW
 CONFIDENTIAL
 2012-04-26

R&D DEPT.

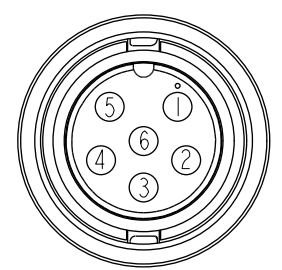
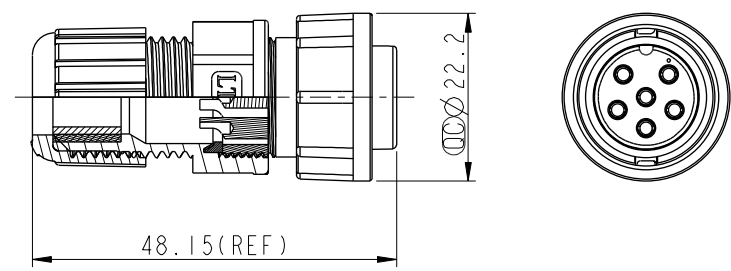

Pin Assignments
Front View

- Note:
- * \varnothing Important Dimension To Check.
 - * Waterproof Rate: IP67
 - * Housing: Nylon+GF, Black.
 - * Female Pin: Copper Alloy, Gold Plated.
 - * O-Ring: EPDM, Black.
 - * Lock Nut: Nylon+GF, Black.
 - * Gasket: EPDM, Black.
 - * Clamp Ring: Nylon, Black.
 - * Sealing Nut: Nylon, Black.
 - * Seals B1 for Cable OD: $\varnothing 7.6\text{mm} \sim \varnothing 9.6\text{MM}$
 - * Seals B2 for Cable OD: $\varnothing 4.0\text{MM} \sim \varnothing 7.6\text{MM}$
 - * One Set Unassembled in One PE Bag.

| | | | | | | | | | | | | | | | | |
|---|--|-----|---------|--|--|---------|------------------|----------|----------|------|-------------|------------------|------------|------------|------|------------|
| UNIT:mm TOLERANCE .X ± 0.25 .XX ± 0.1 .XXX ± 0.05 ANGLES $\pm 1^\circ$ | TITLE Middle, Assy Lock 6Pin F Conn F Pin | | | <h1 style="text-align: center;">Amphenol LTW</h1> <p style="text-align: center;">安費諾亮泰企業股份有限公司</p> | | ITEM NO | CB-06BFFA-LL7001 | DRAWN BY | SamChang | DATE | 2012-04-06 | | | | | |
| | SCALE | 1:1 | SIZE | | | A4 | SHEET | 1 | OF | 1 | DWG NO | CB-06BFFA-LL7001 | CHECKED BY | Jeffrey | DATE | 2012-04-26 |
| | REV. | A | WC-REV. | | | A.2 | Inspection item | | CUSTOMER | ALTW | APPROVED BY | Lion | DATE | 2012-04-26 | | |